

KNOW ALL MEN BY THESE PRESENTS, that Sun Ok Yun, whose address is 1707 Stardust St, Killeen, Texas 76543, being the sole owner of that certain 0.25 tract of land in Bell County, Texas, out of the Original Town of Killeen, which is more fully described in the dedication of YUN FAMILY ADDITION, as shown by the plat hereof, attached hereto, and made a part hereon, and approved by the City Council of the City of Killeen, Bell County, Texas, does hereby adopt said YUN FAMILY ADDITION, as an addition to the City of Killeen, Bell County, Texas, and hereby dedicates to said city all streets, avenues, roads, drives and alleys shown on said plat, the same to be used as public thoroughfares and for the installation and maintenance of public utilities when and as authorized by the City of Killeen. The utility easements shown on said plat are dedicated to said city for installation and maintenance of any and all public utilities which the city may install or permit to be installed or maintained.

Sun Ok Yun, Owner

STATE OF TEXAS
COUNTY OF BELL

This instrument was acknowledged before me on the 30th day of March, 2004 by Sun Ok Yun.

Kathleen L. Kerschmer
NOTARY PUBLIC, STATE OF TEXAS

Approved this 04th day of March, 2004, by the Planning and Zoning Commission of the City of Killeen, Texas.

Larry L. Ch
Chairman, Planning and Zoning Commission

Pamela Smith
Secretary, Planning and Zoning Commission

FILED FOR RECORD this 1st day of April, 2004 A.D.

Cabinet C, Slide 380-A, Plat Records of Bell County, Texas.

Dedication Instrument in Volume 5324, Page 541, Deed Records of Bell County, Texas.

KNOW ALL MEN BY THESE PRESENTS:

That I, Michelle E. Lee, a Registered Professional Land Surveyor, do hereby certify that I prepared this plat from an actual and accurate survey of the land and that the perimeter corner monuments shown hereon were properly placed or found under my supervision, in accordance with the Subdivision and Property Development Regulations of the City of Killeen, Texas. This subdivision, YUN FAMILY ADDITION, is located within the City Limits of Killeen, Texas.

Michelle E. Lee, RPLS (TX 5772)

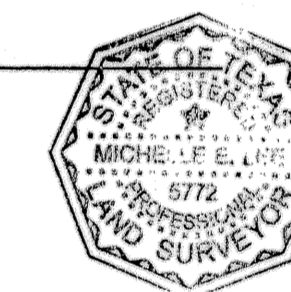

TAX CERTIFICATE

The Bell County Tax Appraisal District, the taxing authority for all entities in Bell County, Texas does hereby certify that there are currently no delinquent taxes due or owing on the property described by this plat.

Dated this 29th day of March, 2004 A.D. Killeen, Bell County, Texas.

BELL COUNTY TAX APPRAISAL DISTRICT

By



FINAL PLAT

YUN FAMILY ADDITION
BEING A REPLAT OF A PORTION OF LOT 2,
BLOCK 68, ORIGINAL TOWN OF KILLEEN
KILLEEN, BELL COUNTY, TEXAS

KILLEEN ENGINEERING
& SURVEYING, LTD.
2901 E. Stan Schlueter Loop
Killeen, Texas 76542
(254) 526-3981 (254) 526-4351 Fax

| | |
|--------------|----------|
| Project No.: | 2004-001 |
| Acres: | 0.25 |
| No. of Lots: | 1 |
| Scale: | 1" = 20' |
| Date: | 02/11/04 |
| Design By: | MEL/BCC |
| Sheet No.: | |