

Note: Unless otherwise noted hereon, all subdivision perimeter corner monuments are 3/8" iron rods with orange caps marked "KILLEEN E&S".



REMAINDER OF GARY W. PURSER 1999 TRUST, AND JOHN HELEN PURSER 1999 TRUST VOL. 4819, PG. 455 169.83 AC

REMAINDER OF GARY W. PURSER 1999 TRUST, AND JOHN HELEN PURSER 1999 TRUST VOL. 4965, PG. 458 190.066 AC

LINE	LENGTH	BEARING
L1	70.00	N 59°37'23" E
L2	4.54	S 17°55'15" E
L3	1.54	S 17°55'15" E
L4	4.54	S 17°55'15" E
L5	1.54	S 17°55'15" E
L6	3.36	S 17°55'15" E
L7	88.25	N 17°55'15" W
L8	88.10	N 48°59'07" E
L9	90.00	S 52°10'30" W
L10	38.64	S 39°40'33" W

CURVE	DELTA	RADIUS	ARC	TANGENT	BEARING	CHORD
C1	14°08'08"	1265.00	312.09	156.84	N 23°18'32" W	311.30
C2	14°08'08"	1300.00	320.73	161.18	N 23°18'32" W	319.92
C3	23°38'48"	330.00	136.19	69.08	N 60°48'31" E	135.23
C4	2°46'51"	1455.00	70.62	35.32	S 43°35'12" E	70.61
C5	36°49'59"	655.00	421.07	218.10	S 63°23'37" E	413.86
C6	43°59'06"	845.00	648.69	341.27	S 59°49'03" E	632.88
C7	2°48'59"	1500.00	73.73	36.87	S 43°34'08" E	73.72
C8	36°49'59"	700.00	450.00	233.08	S 63°23'37" E	442.29
C9	15°44'17"	700.00	192.28	96.75	S 52°50'46" E	191.67
C10	21°05'42"	700.00	257.72	130.34	S 71°15'45" E	256.27
C11	43°59'06"	800.00	614.15	323.10	N 59°49'03" W	599.18
C12	21°29'09"	800.00	300.00	151.78	N 71°04'01" W	298.25
C13	22°29'56"	800.00	314.15	159.12	N 49°04'29" W	312.13
C14	117°03'23"	300.00	61.29	49.01	S 76°28'56" E	51.17
C15	62°56'37"	300.00	329.57	183.64	S 13°33'04" W	313.25
C16	26°06'36"	300.00	136.72	69.57	S 04°51'55" E	135.54
C17	32°24'23"	300.00	169.68	87.18	N 55°52'45" E	167.43
C18	14°24'07"	300.00	75.41	37.90	N 37°49'19" E	75.21

KNOW ALL MEN BY THESE PRESENTS, that GARY W. PURSER 1999 TRUST, JOHN HELEN PURSER 1999 TRUST, and KILLEEN HYMESA, LTD., a Texas Limited Partnership, whose address is 2901 E. Stan Schlueter Loop, being the sole owner of that certain 85.607 Acre tract of land in Bell County, Texas, out of the David B. Harris Survey, Abstract 453, and the Lewis Riddle Survey, Abstract 1096, which is more fully described in the dedication of WHITE ROCK ESTATES, PHASE TWO, as shown by the plat hereof, attached hereto, and made a part hereon, and approved by the City Council of the City of Killeen, Bell County, Texas, does hereby adopt said WHITE ROCK ESTATES, PHASE TWO, as an addition to the City of Killeen, Bell County, Texas, and hereby dedicates to said city all streets, avenues, roads, drives and alleys shown on said plat, the same to be used as public thoroughfares and for the installation and maintenance of public utilities when and as authorized by the City of Killeen. The utility easements shown on said plat are dedicated to said city for installation and maintenance of any and all public utilities which the city may install or permit to be installed or maintained.

GARY W. PURSER 1999 TRUST  
*Gary W. Purser, Sr.*  
 Gary W. Purser, Sr.

JOHN HELEN PURSER 1999 TRUST  
*John Helen Purser*  
 John Helen Purser

KILLEEN HYMESA, LTD.  
*Gary W. Purser, Sr.*  
 Gary W. Purser, Sr.,  
 Custom Homes, Inc., General Partner

*Jon Wade Heiner*  
 Jon Wade Heiner,  
 Heiner, L.L.C., General Partner

STATE OF TEXAS  
 COUNTY OF BELL

This instrument was acknowledged before me on the 22 day of October, 2004 by Gary W. Purser, Sr., John Helen Purser, and Jon Wade Heiner.

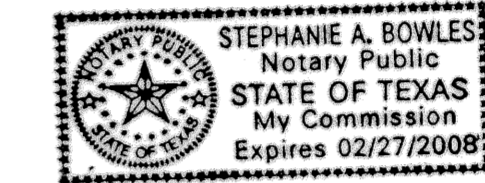

*Stephanie A. Bowles*  
 Stephanie A. Bowles  
 NOTARY PUBLIC, STATE OF TEXAS

Approved this 22 day of November, 2004 by the Planning and Zoning Commission of the City of Killeen, Texas.

*James L. Call*  
 Chairman, Planning and Zoning Commission  
*David Abper*  
 Secretary, Planning and Zoning Commission

Approved this 14 day of December, 2004 by the City Council of the City of Killeen, Texas.

*Manuel J. Jones*  
 Mayor  
*Paula A. Miller*  
 City Secretary

FILED FOR RECORD this 28 day of January, 2005 A.D.

Cabinet D, Slide 35C-D Plat Records of Bell County, Texas.

Dedication Instrument in Volume 5598, Page 851, Deed Records of Bell County, Texas.

KNOW ALL MEN BY THESE PRESENTS:

That I, Michelle E. Lee, a Registered Professional Land Surveyor, do hereby certify that I prepared this plat from an actual and accurate survey of the land and that the perimeter corner monuments shown hereon were properly placed or found under my supervision, in accordance with the Subdivision and Property Development Regulations of the City of Killeen, Texas. This subdivision, WHITE ROCK ESTATES, PHASE TWO, is located within the City Limits of Killeen, Texas.

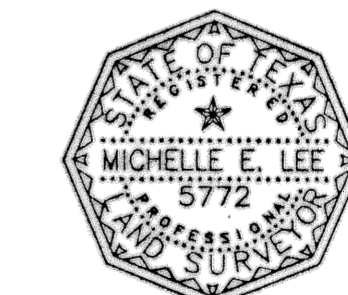

*Michelle E. Lee 1-12-05*  
 Michelle E. Lee, RPLS (TX 5772)

TAX CERTIFICATE

The Bell County Tax Appraisal District, the taxing authority for all entities in Bell County, Texas does hereby certify that there are currently no delinquent taxes due or owing on the property described by this plat.

Dated this 18 day of January, 2005 A.D. Killeen, Bell County, Texas.

BELL COUNTY TAX APPRAISAL DISTRICT  
 By: *Tenny T. Lewis*

FINAL PLAT

KILLEEN ENGINEERING & SURVEYING, LTD.

2901 E. Stan Schlueter Loop  
 Killeen, Texas 76542

(254) 526-3981 (254) 526-4351 Fax

WHITE ROCK ESTATES  
 PHASE TWO  
 KILLEEN, BELL COUNTY, TEXAS

Project No.:	1009-002
Acres:	85.607
No. of Lots:	233
Scale:	1" = 100'
Date:	10/20/04
Design By:	GWP/BCC
Sheet No.:	1 OF 2