

KNOW ALL MEN BY THESE PRESENTS, that Monty VanDyke, whose address is 13763 FM 2484, Salado, Texas 76571, being the sole owner of that certain 3.0 tract of land in Bell County, Texas, part of the Azra Webb Survey, Abstract 857, which is more fully described in the dedication of VANDYKE ADDITION, as shown by the plat hereof, attached hereto, and made a part hereon, and approved by the City Council of the City of Killeen, Bell County, Texas, does hereby adopt said VANDYKE ADDITION, as an addition to the City of Killeen, Bell County, Texas, and hereby dedicates to said city all streets, avenues, roads, drives and alleys shown on said plat, the same to be used as public thoroughfares and for the installation and maintenance of public utilities when and as authorized by the City of Killeen. The utility easements shown on said plat are dedicated to said city for installation and maintenance of any and all public utilities which the city may install or permit to be installed or maintained.

*Monty VanDyke*  
Monty VanDyke, Owner

STATE OF TEXAS  
COUNTY OF BELL

This instrument was acknowledged before me on the 17 day of September 2003 by Monty VanDyke.

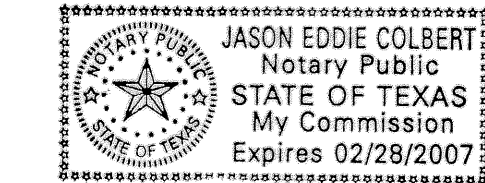

*Jason E. Colbert*  
NOTARY PUBLIC, STATE OF TEXAS

Approved this 22nd day of September 2003, by the Planning and Zoning Commission of the City of Killeen, Texas.

*James L. Col*  
Chairman, Planning and Zoning Commission

*Pamela Smith*  
Secretary, Planning and Zoning Commission

Approved this 14th day of October 2003, by the City Council of the City of Killeen, Texas.

*Maurice J. Jones*  
Mayor

*Paula G. Smith*  
City Secretary

FILED FOR RECORD this 5th day of December, 2003 A.D.  
Cabinet C, Slide 361-2, Plat Records of Bell County, Texas.  
Dedication Instrument in Volume 5219, Page 659, Deed Records of Bell County, Texas.

KNOW ALL MEN BY THESE PRESENTS:  
That I, A.W. Kessler, a Registered Professional Land Surveyor, do hereby certify that I prepared this plat from an actual and accurate survey of the land and that the perimeter corner monuments shown hereon were properly placed or found under my personal supervision, in accordance with the Subdivision and Property Development Regulations of the City of Killeen, Texas. This subdivision, VANDYKE ADDITION, is located within the City Limits of Killeen, Texas.

*A.W. Kessler* 9-16-03  
A.W. Kessler, RPLS (TX 1852)



TAX CERTIFICATE  
The Bell County Tax Appraisal District, the taxing authority for all entities in Bell County, Texas does hereby certify that there are currently no delinquent taxes due or owing on the property described by this plat.  
Dated this 28th day of October, 2003 A.D. Killeen, Bell County, Texas.  
BELL COUNTY TAX APPRAISAL DISTRICT  
By: *Dennis T. Lewis*

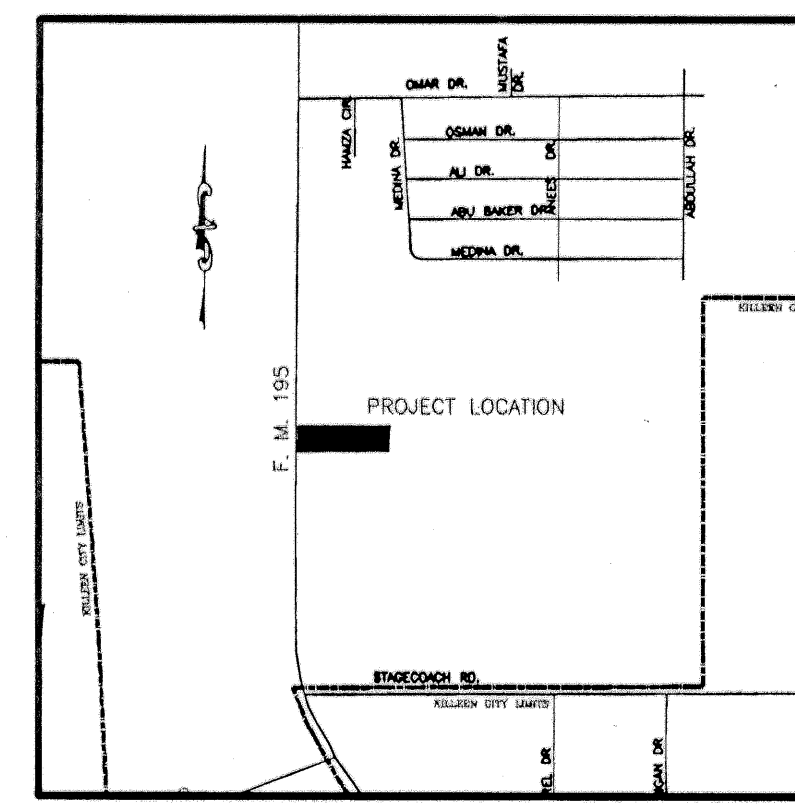

VICINITY MAP  
N.T.S.

**KILLEEN ENGINEERING  
& SURVEYING, LTD.**  
2901 E. Stan Schlueter Loop  
Killeen, Texas 76542  
(254) 526-3981 (254) 526-4351 Fax

FINAL PLAT

VANDYKE ADDITION  
KILLEEN, BELL COUNTY, TEXAS

Project No.:	2003-034
Acres:	3.00
No. of Lots:	1
Scale:	1" = 100'
Date:	8/23/03
Design By:	JEC
Sheet No.:	