

SCHOOL TRACT

TRIMMIE HEIGHTS

CANDICE LANE

BACON RANCH ROAD

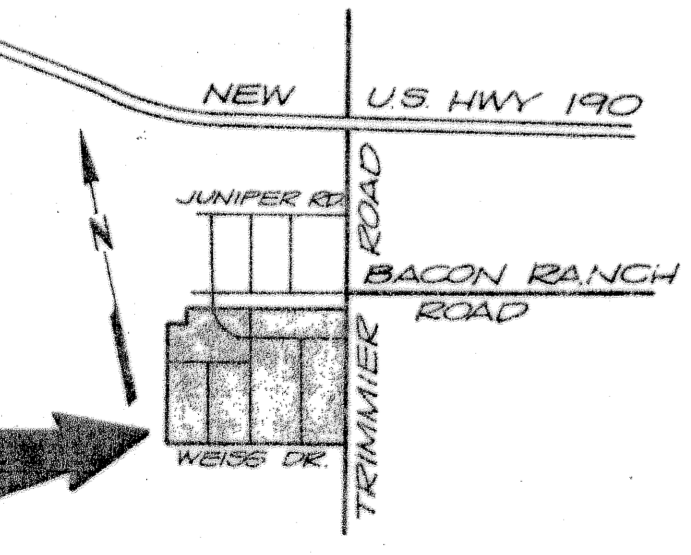

VICINITY MAP
N.T.S.

NOTE
UTILITY EASEMENTS ARE 7' OFF PROPERTY LINES.
TURTLE BEND AND TORTOISE LANE ARE 60' R.O.W.
REMAINDER OF STREETS ARE 50' R.O.W.

CURVE #1		
INNER	OUTER	
Δ 43°54'40"	43°54'40"	4048'30"
R 223.00	223.00	280.00
T 49.95	118.56	157.19
L 187.60	213.15	232.77
C 181.97	206.78	231.60

CURVE #2		
INNER	OUTER	
Δ 47°00'55"	47°00'55"	4048'30"
R 223.40	223.40	285.40
T 54.31	118.24	106.17
L 161.35	162.35	203.25
C 157.95	178.47	197.0

KNOW ALL MEN BY THESE PRESENTS, that Turtle Bend, Inc., whose address is P.O. Box 787, Killeen, Texas, acting by and through its duly authorized officers, Jack Barnes and Don Farek, being the sole owner of that certain 5334 acre tract out of the John Essery Survey, Abstract No. 296, Killeen, Bell County, Texas, which if fully described in the Dedication of Turtle Bend, do hereby subdivide said land into lots and blocks to be known as Turtle Bend, as shown by the plat hereof, attached hereto, and made a part hereof, and approved by the City Council of the City of Killeen, Bell County, Texas, and Turtle Bend, Inc., do hereby adopt said plat of Turtle Bend as an addition to the City of Killeen, Bell County, Texas, and for the purpose of selling lots and blocks of land with reference thereto and for all other purposes; and do hereby dedicate to the City of Killeen all streets, avenues, roads, drives, and alleys shown on said plat, the same to be used as public thoroughfares and for the installation and maintenance of public utilities, when and as authorized by the City of Killeen. The utility easements shown on said plat are dedicated to the City of Killeen for installation and maintenance of any and all public utilities which said City may elect to install and maintain or permit to be installed and maintained.

Jack Barnes
Jack Barnes, President

Don Farek
Don Farek, Secretary-Treasurer

Alta Barnes
Alta Barnes, Vice-President

Sonya Farek
Sonya Farek, Vice-President

BEFORE ME, the undersigned, a Notary Public in and for said County and State, on this day personally appeared JACK BARNES, PRESIDENT, known to me to be the persons and officers whose names are subscribed to the foregoing instrument and acknowledged to me that the same was the act of the said Turtle Bend, Inc., a corporation, and that they executed the same as the act of such corporation for the purposes and consideration therein expressed and in the capacity therein stated.

GIVEN under my hand and seal of office, this the 12th day of November, A.D., 1975.

Barry England
Notary Public in and for Bell County, Tex.

APPROVED this the 12th day of Nov, A.D., 1975 by the Planning Commission of the City of Killeen, Texas.

Don Farek
Chairman, Planning Commission

J. M. Kauff
Secretary, Planning Commission

APPROVED this the 25th day of NOV, A.D., 1975, by the City Council of the City of Killeen, Texas.

Brian Quinn
Mayor

John H. ...
City Secretary

FILED FOR RECORD this 18 day of DEC, A.D., 1975, in Plat Book Vol. 1361, Page 171, Deed Records of Bell County, Texas.

KNOW ALL MEN BY THESE PRESENTS: that I, Roy L. Dunlap, Registered Professional Engineer, do certify that I did cause to be surveyed on the ground the said tract of land and that the corner monuments shown thereof were properly placed in accordance with the Subdivision Regulations of the City of Killeen, Texas.

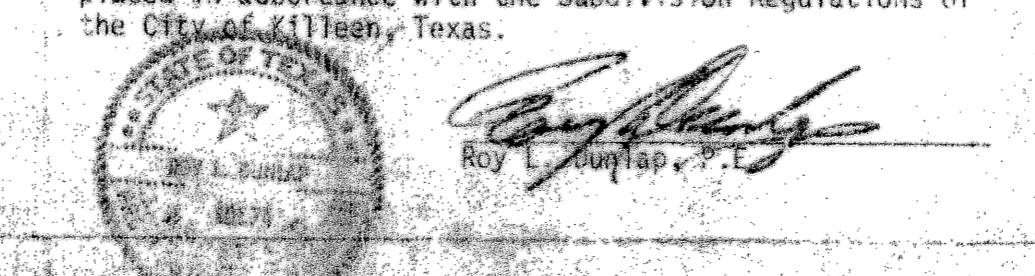

**FINAL PLAT
TURTLE BEND**

DUNLAP & ASSOCIATES
CONSULTING ENGINEERS

Killeen, Texas

DATE OCT 1975	DESIGNED BY JLR	DRAWN BY JLR	APPROVED BY
SCALE 1" = 100'	SHEET NO. OF	FILE NO. K-75051	