

INSET 'A'  
TABERNAACLE OF PRAISE ADDITION  
(CABINET C, SLIDE 294-C)  
N.T.S.

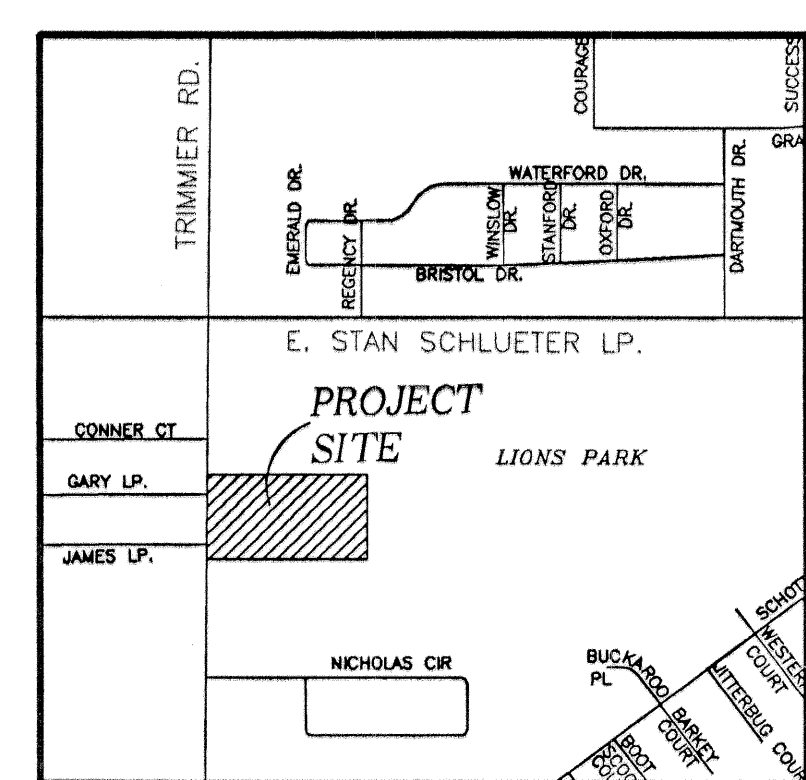

VICINITY MAP  
N.T.S.

KNOW ALL MEN BY THESE PRESENTS, that Tabernacle of Praise Pentecostal Church, Inc., whose address is 5010 Trimmer Road, Killeen, Texas 76542, being the sole owner of that 11.830 acre tract of land in Bell County, Texas, which is more fully described in the dedication of Tabernacle of Praise Addition Replat, Being a Replat of Lot 1, Block 1, Tabernacle of Praise Addition, as shown by the plat hereof, attached hereto, and made a part hereon, and approved by the City Council of the City of Killeen, Bell County, Texas, does hereby adopt said Tabernacle of Praise Addition Replat, Being a Replat of Lot 1, Block 1, Tabernacle of Praise Addition, as an addition to the City of Killeen, Bell County, Texas, and hereby dedicates to said city all streets, avenues, roads, drives and alleys shown on said plat, the same to be used as public thoroughfares and for the installation and maintenance of public utilities when and as authorized by the City of Killeen. The utility easements shown on said plat are dedicated to said city for installation and maintenance of any and all public utilities which the city may install or permit to be installed or maintained.

For: Tabernacle of Praise Pentecostal Church, Inc.

*Donnie Talley*  
Donnie Talley, Director/Agent

STATE OF TEXAS  
COUNTY OF BELL

This instrument was acknowledged before me on the 9<sup>th</sup> day of January, 2007 by Donnie Talley.

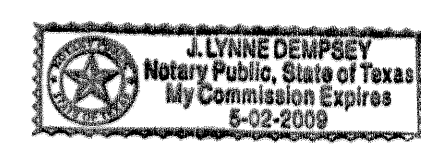

*J. Lynne Dempsey* 5/2/09  
Notary Public, State of Texas

Approved this 22 day of January, 2007, by the Planning and Zoning Commission of the City of Killeen, Texas.

*John Grudal*  
Chairman, Planning and Zoning Commission  
*Trish Hanker*  
Secretary, Planning and Zoning Commission

Approved this 13 day of February, 2007, by the City Council of the City of Killeen, Texas.

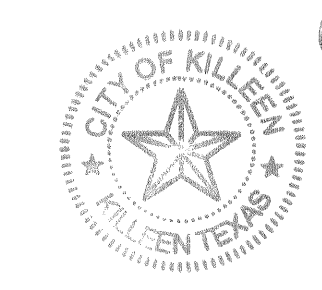

*Christy L. Hancock*  
Mayor  
*Buck W. Miller*  
City Secretary

FILED FOR RECORD this 16<sup>th</sup> day of February 2007 A.D.

Cabinet D, Slide 114-A, Plat Records of Bell County, Texas.

Dedication Instrument in Volume N/A, Page N/A, Deed Records of Bell County, Texas.  
instrument number: 2007-00007839

KNOW ALL MEN BY THESE PRESENTS:

That I, Michelle E. Lee, a Registered Professional Land Surveyor, do hereby certify that I prepared this plat from an actual and accurate survey of the land and that the perimeter corner monuments shown hereon were properly placed or found under my personal supervision, in accordance with the Subdivision Regulations of the City of Killeen, Texas. This subdivision, Tabernacle of Praise Addition Replat, Being a Replat of Lot 1, Block 1, Tabernacle of Praise Addition, is located within the City Limits of Killeen, Texas.

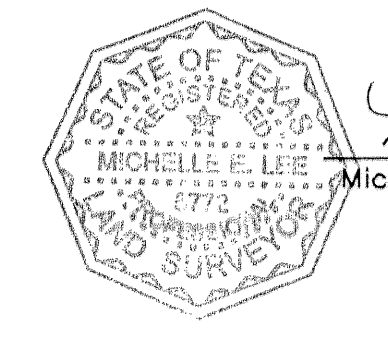

*Michelle E. Lee* 1-3-07  
Michelle E. Lee, RPLS (TX 5772)

TAX CERTIFICATE

The Bell County Tax Appraisal District, the taxing authority for all entities in Bell County, Texas does hereby certify that there are currently no delinquent taxes due or owing on the property described by this plat.

Dated this 30<sup>th</sup> day of January, 2007 A.D.

BELL COUNTY TAX APPRAISAL DISTRICT

By: *Terry T. Lewis*

**KILLEEN ENGINEERING & SURVEYING, LTD.**  
2901 E. Stan Schlueter Loop  
Killeen, Texas 76542  
(254) 526-3981 (254) 526-4351 Fax

**TABERNAACLE OF PRAISE ADDITION REPLAT,  
BEING A REPLAT OF LOT 1, BLOCK 1,  
TABERNAACLE OF PRAISE ADDITION  
KILLEEN, BELL COUNTY, TEXAS**

FINAL PLAT

|              |            |
|--------------|------------|
| Project No.: | 2006-082   |
| Acre:        | 11.830     |
| No. of Lots: | 2          |
| Scale:       | 1" = 100'  |
| Date:        | 11/15/2006 |
| Design By:   | MEL/CDD    |
| Sheet No.:   | 1 OF 1     |