

KNOW ALL MEN BY THESE PRESENTS, that DAVID RICHARD SPRIGGS, whose address is 614 Fort Hood Street, Killeen, Texas, being the sole owner of that certain 0.330 acre tract out of the Alex Thompson Survey, Abstract No. 813, which is more fully described in the Dedication of SPRIGGS SUBDIVISION, OF PART OF LOT 3, BLOCK A, SPOFFORD ADDITION, as shown by the plat hereof, attached hereto, and made a part hereon, and approved by the City Council of the City of Killeen, Bell County, Texas, and DAVID RICHARD SPRIGGS does adopt said SPRIGGS SUBDIVISION, OF PART OF LOT 3, BLOCK A, SPOFFORD ADDITION, as an Addition to the City of Killeen, Bell County, Texas, and hereby dedicates to said City all streets, avenues, roads, drives and alleys shown on said plat, the same to be used as public thoroughfares and for the installation and maintenance of public utilities when and as authorized by the City of Killeen. The utility easements shown on said plat are dedicated to the City of Killeen for the installation and maintenance of any and all public utilities, which the City may install or permit to be installed or maintained.

*David Richard Spriggs*  
 DAVID RICHARD SPRIGGS

BEFORE ME, the undersigned, a Notary Public in and for said County and State, on this day personally appeared DAVID RICHARD SPRIGGS, known to me to be the person whose name is subscribed to the foregoing instrument and acknowledged to me that the same was the act of said DAVID RICHARD SPRIGGS, and that he executed the same for the purpose and consideration therein expressed.

GIVEN UNDER MY HAND AND SEAL OF OFFICE, THIS 28<sup>th</sup> DAY OF May, 19 85.

*Jace M. Stubbins*  
 NOTARY PUBLIC FOR STATE OF TEXAS

APPROVED this the 4<sup>th</sup> day of June, 19 85, by the Planning Commission of the City of Killeen, Bell County, Texas.

*John Blue* CHAIRMAN, PLANNING COMMISSION  
*Jace M. Stubbins* SECRETARY, PLANNING COMMISSION

APPROVED this the 11<sup>th</sup> day of June, 19 85, by the City Council of the City of Killeen, Bell County, Texas.

*Gale E. Mitchell* MAYOR, CITY OF KILLEEN  
*Murray L. D. D. D.* ATTEST: CITY SECRETARY

FILED FOR RECORD this 13 day of JUNE, 19 85, in Cabinet A, Slide 381-C, Plat Records of Bell County, Texas. VOL. 2062 PG. 139

KNOW ALL MEN BY THESE PRESENTS, That I, Gale E. Mitchell, Registered Public Surveyor, do hereby certify that I did prepare this plat from an actual and accurate survey of the land, that the corner monuments shown thereon were properly placed under my personal supervision in accordance with the subdivision regulations of the City of Killeen, Texas, and this subdivision is within the City Limits of Killeen, Bell County, Texas.

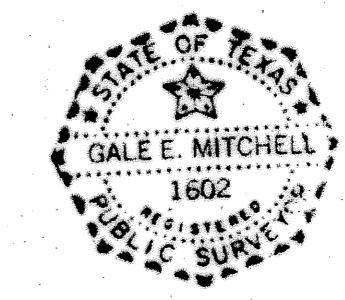

*Gale E. Mitchell*  
 Gale E. Mitchell  
 Registered Public Surveyor  
 No. 1602

*Fort Hood Military Reservation*

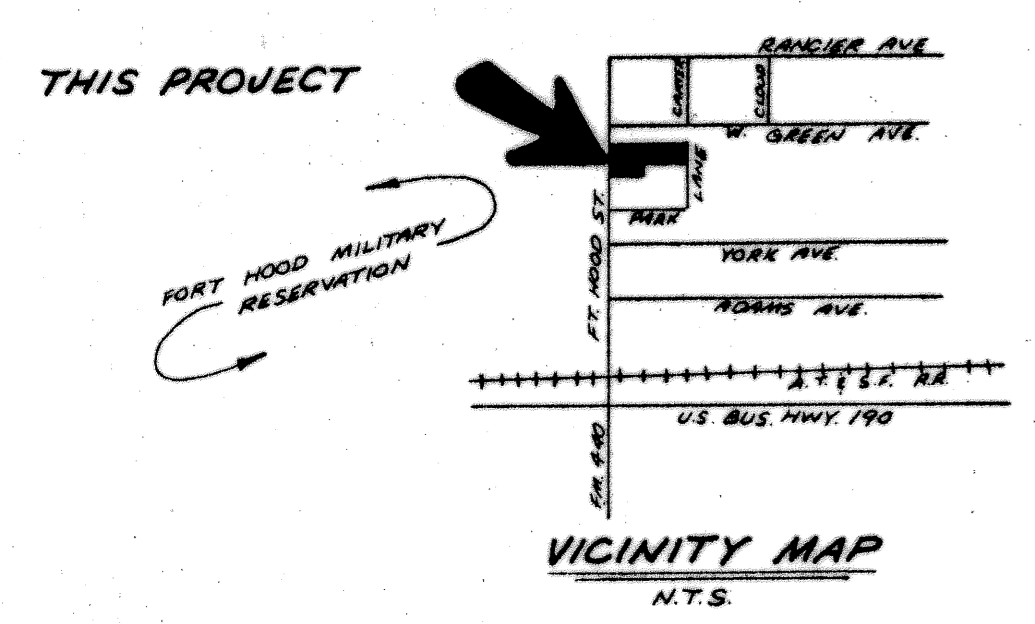
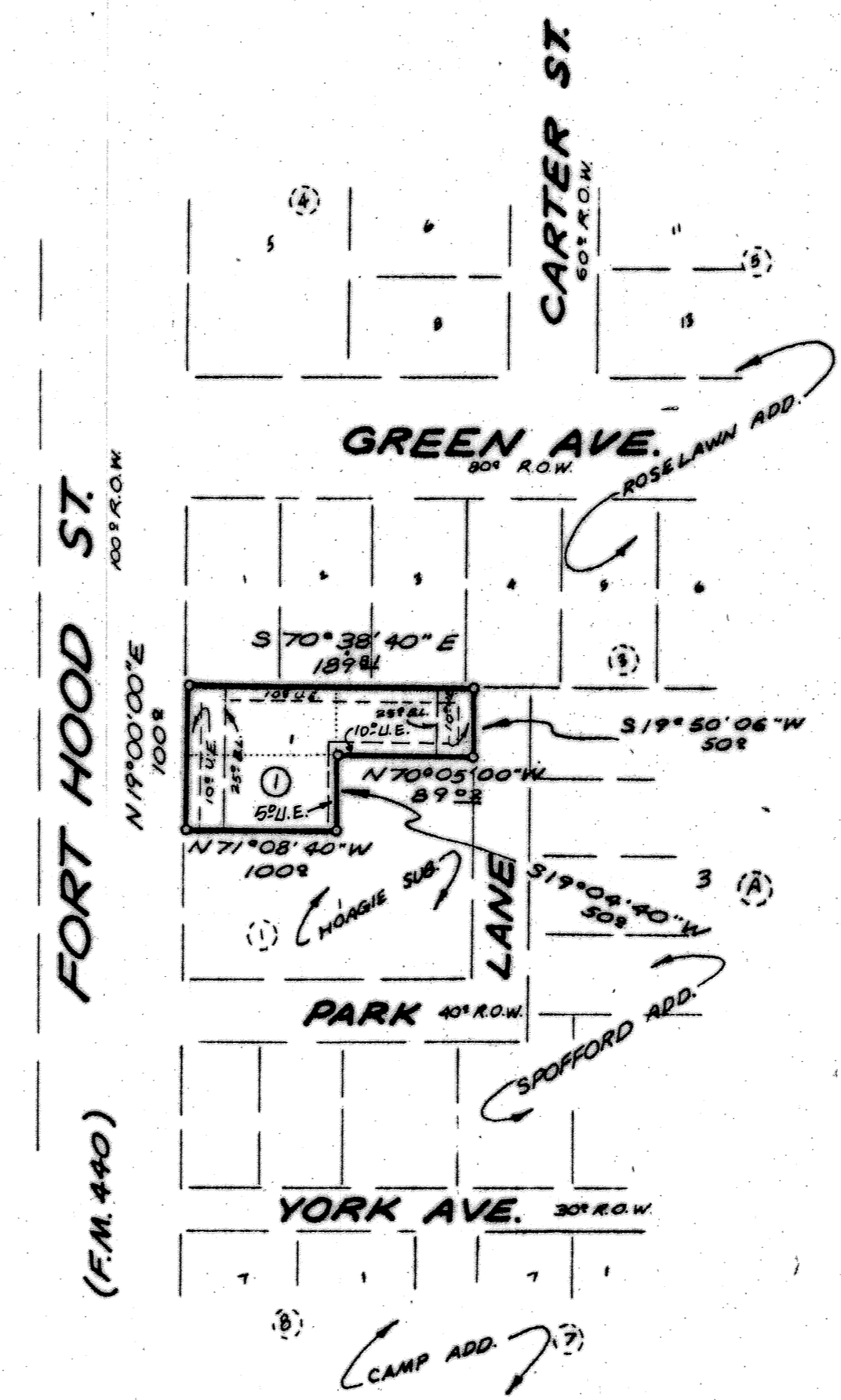

FINAL PLAT

1 LOT  
 0.330 Ac.  
**SPRIGGS SUBDIVISION**  
 OF PART OF LOT 3, BLOCK A,  
 SPOFFORD ADDITION,  
 KILLEEN, BELL COUNTY, TEXAS

**WATWOOD-MITCHELL, INC.**  
 ENGINEERING & SURVEYING  
 Killeen, Texas Temple, Texas

DATE: APRIL '85	SCALE: 1" = 100'	DRAWN BY: WH	REF. NO.	DWG. NO. 2616-D
--------------------	---------------------	-----------------	----------	--------------------