

LINE	LENGTH	BEARING
L1	69.30	N71°00'00"W
L2	85.11	N19°29'59"E
L3	66.34	S70°53'06"E
L4	85.04	S17°30'08"W

KEYED NOTES	
① JAMES E. etux ROSWITHA I. CRANDELL (VOL. 4254, PAGE 26)	⑨ DONALD R. etux TONG Y. COOLEY (VOL. 4316, PAGE 25)
② MARIE A. McAULIFFE (VOL. 4061, PAGE 195)	⑩ JAMES H. etux DIANE HORRY (VOL. 4043, PAGE 122)
③ OK KUM LOWE (VOL. 3395, PAGE 254)	⑪ JAMES H. etux DIANE HORRY (VOL. 4043, PAGE 122)
④ DEAN & TUENJIT S. KOZEL (VOL. 4737, PAGE 198)	⑫ BENNY M. DAILEY (VOL. 4678, PAGE 117)
⑤ ZACHARY R. etux SILECZANDRA K. POOLE (VOL. 5485, PAGE 722)	⑬ STEWART H. ROBERTS (VOL. 2704, PAGE 606)
⑥ TRACEY LEE HAAK (VOL. 3305, PAGE 71)	⑭ CHARLOTTE M. BENTON (VOL. 1653, PAGE 168)
⑦ TRACEY LEE HAAK (VOL. 3305, PAGE 71)	⑮ FEDERAL NATIONAL MORTGAGE ASSOCIATION (VOL. 5503, PAGE 777)
⑧ JAMES CLEO BUNDRANT (VOL. 1562, PAGE 357)	

**NOTE:**  
SEE BOARD OF ADJUSTMENTS & APPEALS (ZONING), BOARD ORDER No. Z0515672 TO WAIVE OR REDUCE THE FRONT YARD, LOT DEPTH, AND LOT AREA REQUIREMENT.

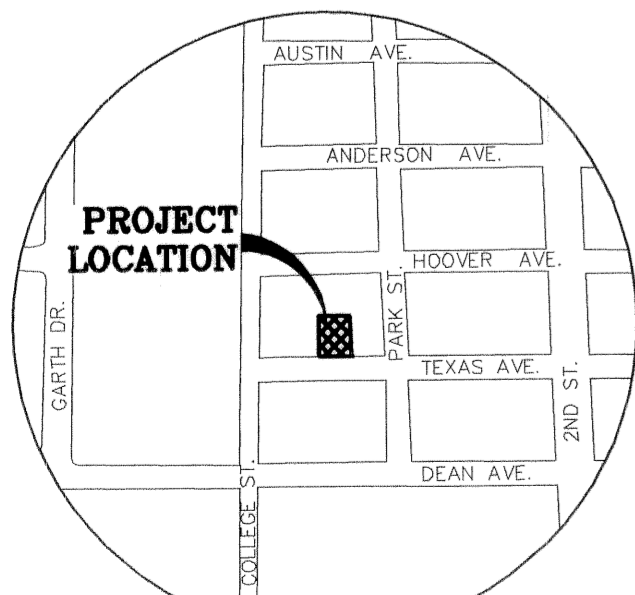

VICINITY MAP  
SCALE: N.T.S.

KNOW ALL MEN BY THESE PRESENTS, that Micheal E. Sleighter, whose address is 240 West Wood Lawn, Apartment 2, San Antonio, Texas 78212, being the sole owner(s) of that certain 0.132 acre tract of land in Bell County, Texas, part of the Hadden O'Neal Survey, Abstract No. 645, which is more fully described in the dedication of SLEIGHTER ADDITION, BEING A REPLAT OF PART OF LOTS 1, 2, & 3, BLOCK 29, NORTHSIDE ADDITION as shown by the plat hereof, attached hereto, and made a part hereon, and approved by the Planning & Zoning Commission of the City of Killeen, Bell County, Texas, and Micheal E. Sleighter does hereby adopt said SLEIGHTER ADDITION, BEING A REPLAT OF PART OF LOTS 1, 2, & 3, BLOCK 29, NORTHSIDE ADDITION as an addition to the City of Killeen, Bell County, Texas, and hereby dedicates to said city all streets, avenues, roads, drives and alleys shown on said plat, the same to be used as public thoroughfares and for the installation and maintenance of public utilities when and as authorized by the City of Killeen. The utility easements shown on said plat are dedicated to said city for the installation and maintenance of any and all public utilities, which the city may install or permit to be installed or maintained.

WITNESS the execution hereof, on this 21<sup>st</sup> day of December, 2005.

*Micheal E. Sleighter*  
Micheal E. Sleighter

Before me, the undersigned authority, on this day personally appeared Micheal E. Sleighter known to me to be the person whose name is subscribed to the foregoing instrument. It has been acknowledged to me that he executed the foregoing instrument as the owner of the property described hereon.

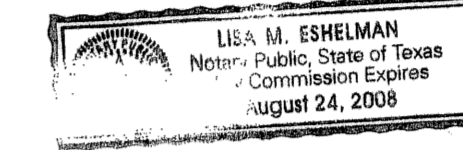

*Lisa M. Eshelman*  
NOTARY PUBLIC STATE OF TEXAS  
My Commission Expires: 8-24-08

APPROVED this the 23<sup>rd</sup> day of January, 2006, by the Planning and Zoning Commission of the City of Killeen, Bell County, Texas.

*John K. Collier*  
CHAIRMAN, PLANNING COMMISSION

*Picki Hanken*  
SECRETARY, PLANNING COMMISSION

KNOW ALL MEN BY THESE PRESENTS,

That I, Robert E. Mitchell, Registered Professional Land Surveyor, do hereby certify that I did prepare this plat from an actual and accurate survey of the land, that the corner monuments shown hereon were properly placed under my personal supervision in accordance with the subdivision regulations of the City of Killeen, Texas, and this subdivision is within the City Limits of Killeen, Texas.

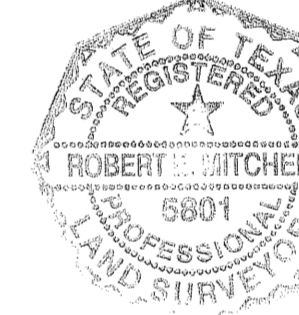

*Robert E. Mitchell*  
Robert E. Mitchell, R.P.L.S.  
Registered Professional Land Surveyor, No. 5801

The Bell County Tax Appraisal District, the taxing authority for all entities in Bell County, Texas does hereby certify that there are currently no delinquent taxes due or owing on the property described by this plat.  
Dated this 21<sup>st</sup> day of January, A.D. 2006  
BELL COUNTY TAX APPRAISAL DISTRICT  
By: *Thomas T. Lewis*

FILE FOR RECORD this 24<sup>th</sup> day of February, 2006, in Cabinet D, Slide 100-B, Plat Records of Bell County, Texas. Dedication Instrument in Volume 8981, Page 116, Deed Records of Bell County, Texas.

MITCHELL & ASSOCIATES, INC.  
ENGINEERING & SURVEYING  
102 N. COLLEGE STREET  
KILLEEN, TEXAS 76541  
PHONE: (254) 634-5541  
FAX: (254) 634-2141

DWG No. 05-542-D	DATE: OCT. 2005	SCALE: 1"=100'	AREA: 0.132 AC.
FRB	DATE: OCT. 2005	SCALE: 1"=100'	AREA: 0.132 AC.
FRB	DATE: OCT. 2005	SCALE: 1"=100'	AREA: 0.132 AC.
FRB	DATE: OCT. 2005	SCALE: 1"=100'	AREA: 0.132 AC.

SLEIGHTER ADDITION  
BEING A REPLAT OF PART OF LOTS 1, 2, & 3, BLOCK 29, NORTHSIDE ADDITION  
KILLEEN, BELL COUNTY, TEXAS

FINAL PLAT

SHEET TITLE

1	1-6-06	DATE	REVISIONS	BY