

599/515

SIMMONSVILLE SUBDIVISION  
By J.R. Simmons, Bell Co.

The Plat hereon is a subdivision of land out of a survey originally granted to A. Dickson and being part of the 70 acre tract conveyed by Jno. Rose to J.R. Simmons by Deed Recorded in Vol. 520, Page 447 Deed Records, Bell County, Tex., and begins at the S.E. cor of said 70 A. tract. This being point of intersection of the North Line of Hy. No. 190 and the west line of a 30 ft. Roadway conveyed by me to the City of Killeen. The lots vary in size as shown on plat and I hereby donate and set apart for the use and benefit of the public all streets and avenues as shown on the plat of this subdivision.

Given under my hand this 13th day of June, 1949.  
J. R. Simmons

STATE OF TEXAS, COUNTY OF BELL. BEFORE ME ON this day personally appeared J.R. Simmons known to me to be the person whose name is subscribed to the foregoing instrument and acknowledged to me that he executed the same for the purposes and consideration therein expressed.  
Given under my hand and seal of office this 13 day of June, 1949.

Ted Whitlow  
Notary Public, Bell County, Texas

(SEAL)

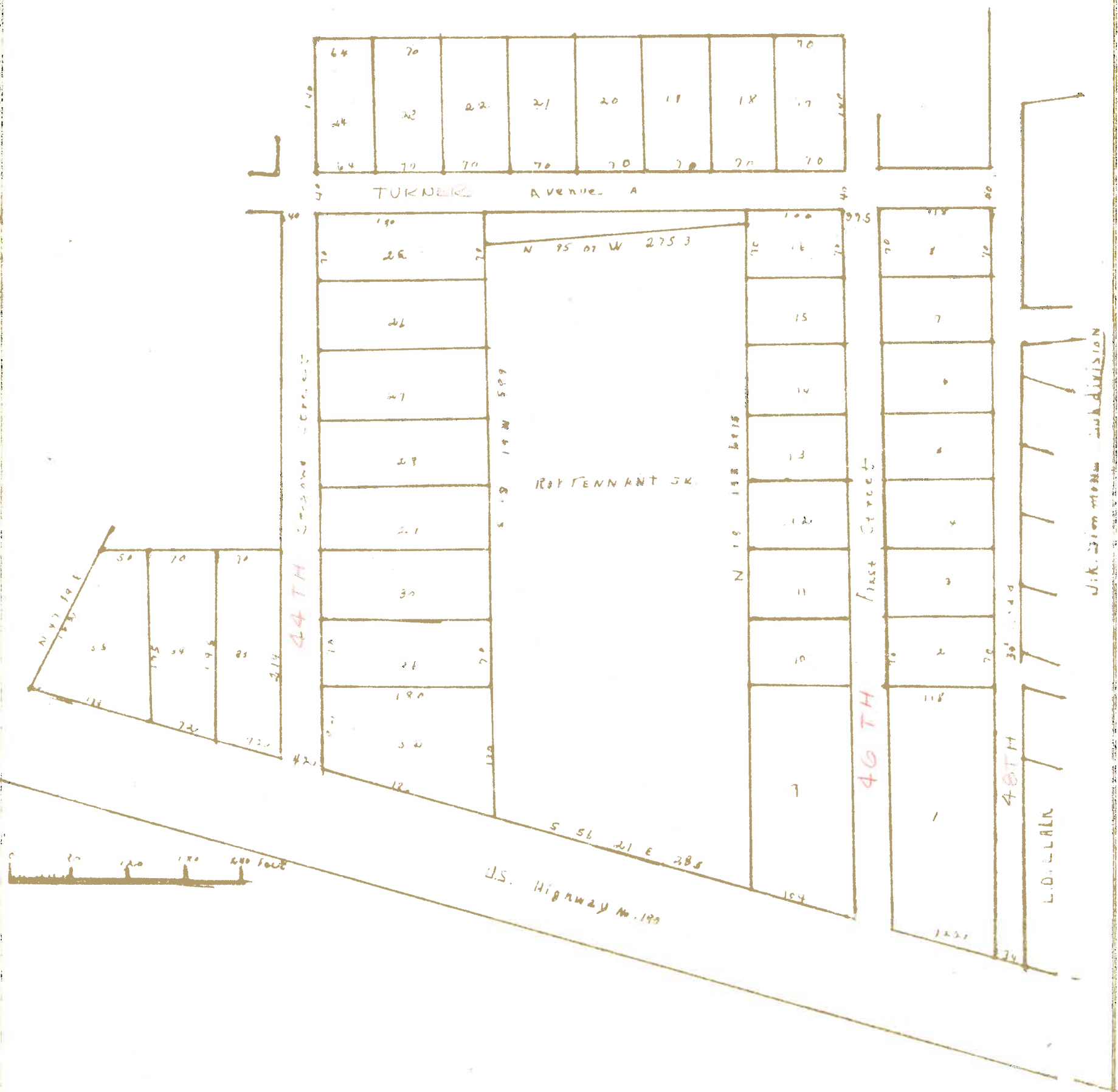

This plat & Subdivision, presented and approved in open Court. Dated this 30th day of June, A.D. 1949.

W.A. Messer, County Judge

Mrs. Sam Moore, County Clerk & Exofficio Clerk (SEAL)  
Commissioners Court, Bell County, Texas.

Filed for Record June 30, 1949 at 4 o'clock P.M.

Mrs. Sam Moore, County Clerk, Bell County, Texas  
By - F. Stewart, Deputy