

KNOW ALL MEN BY THESE PRESENTS, that W&B Development, Ltd., whose address is 3000 Illinois Ave. Ste. 100, Killeen, TX. 76543, being sole owner of certain 31.20 acres tract of land in Bell County, Texas, part of the Robert Cunningham Survey, Abstract No. 158, Bell County, Texas, which is more fully described in the dedication of SAVANNAH HEIGHTS, PHASE III, as shown by the plat hereof, attached hereto, and made a part hereof, and approved by the City Council of the City of Killeen, Bell County, Texas, and W&B Development, Ltd., do hereby adopt said SAVANNAH HEIGHTS, PHASE III, as an addition to the City of Killeen, Bell County, Texas, and hereby dedicates to said city all streets, avenues, roads, drives, and alleys shown on said plat, the same to be used as public thoroughfares and for the installation and maintenance of public utilities when and as authorized by the City of Killeen. The utility easements shown on said plat are dedicated to said city for the installation and maintenance of any and all public utilities, which the city may install or permit to be installed or maintained.

WITNESS the execution hereof, on this 27th day of April, 2006

For: W&B Development, Ltd.
By: G.W. Development, Inc.
General Partner



Bruce Whitis, Vice President & Secretary-Treasurer

Before me, the undersigned authority, on this day personally appeared Bruce Whitis known to me to be the person whose name is subscribed to the foregoing instrument. It has been acknowledged to me that he executed the foregoing instrument as the owner of the property described hereon.

Brenda Clanton
NOTARY PUBLIC STATE OF TEXAS
My Commission Expires: 08-20-07

APPROVED this the 27th day of March, 2006 by the Planning and Zoning Commission of the City of Killeen, Bell County, Texas.

John Fubler
CHAIRMAN, PLANNING COMMISSION

Fricki Hoaken
SECRETARY, PLANNING COMMISSION

APPROVED this the 25th day of April, 2006 by the City Council of the City of Killeen, Bell County, Texas.

Simothy L. Hester
MAYOR, CITY OF KILLEEN

Paula W. Miller
ATTEST: CITY SECRETARY

FILED FOR RECORD this 19th day of December, 2006 in Cabinet D, Slide 155-D, Plat Records of Bell County, Texas. Instrument number: 2006-00058308

STATE OF TEXAS
COUNTY OF BELL

I, A. W. KESSLER, REGISTERED PROFESSIONAL LAND SURVEYOR DO HEREBY CERTIFY THAT I DID CAUSE THE PLAT ATTACHED HERETO TO BE PREPARED FROM AN ACTUAL SURVEY MADE ON THE GROUND AND THAT ALL CORNER MONUMENTS WERE PLACED UNDER MY SUPERVISION IN ACCORDANCE WITH THE SUBDIVISION REGULATIONS OF THE CITY OF KILLEEN, BELL COUNTY, TEXAS.

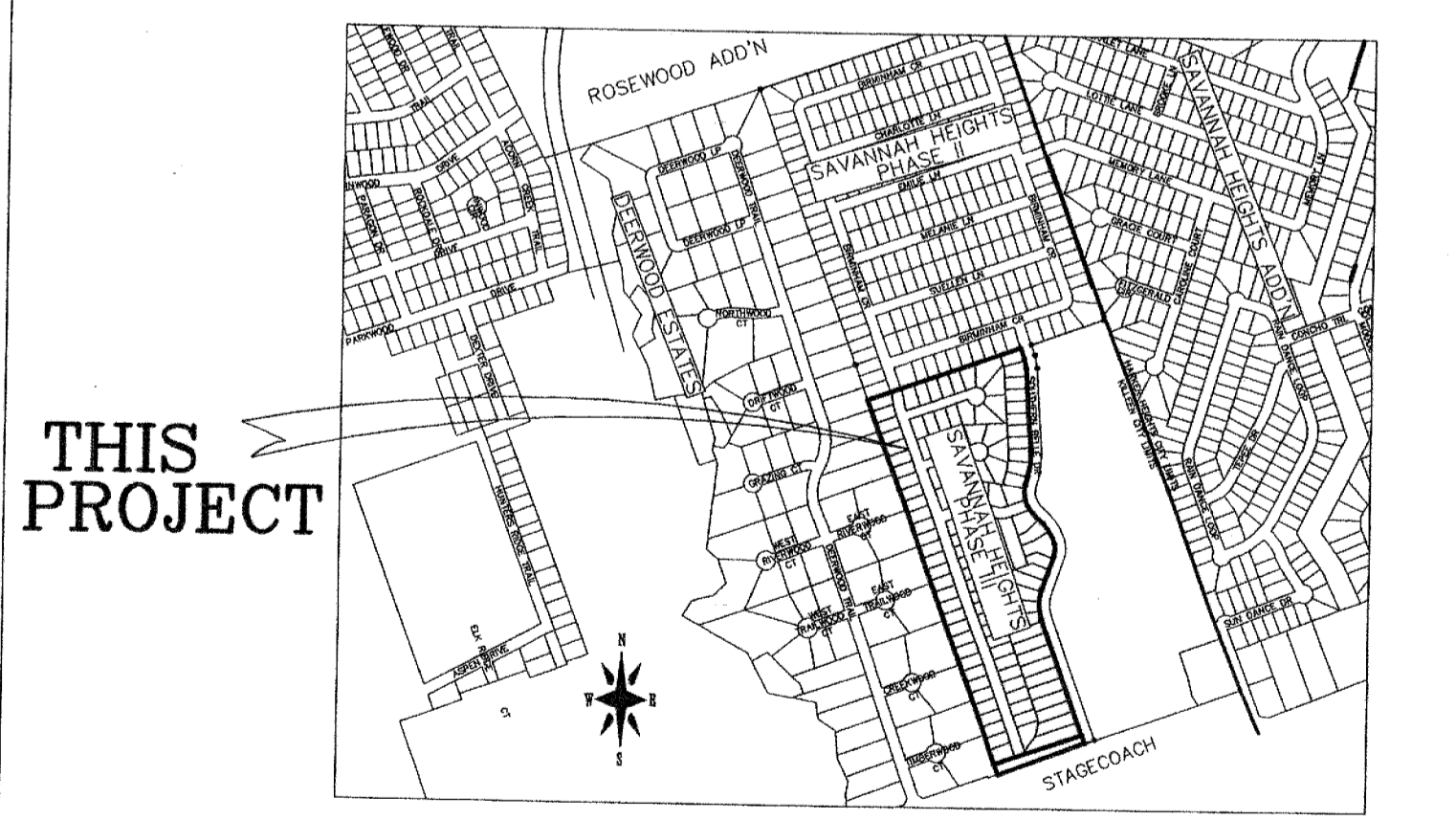
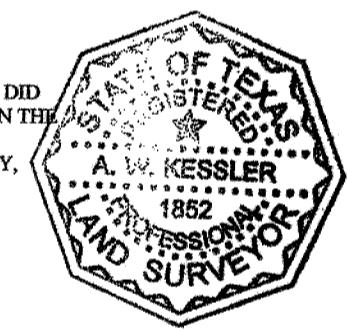

THIS PROJECT

VICINITY MAP
N.T.S.

FINAL PLAT OF
SAVANNAH HEIGHTS, PHASE III
PART OF THE ROBERT CUNNINGHAM SURVEY, ABSTRACT NO. 158
BELL COUNTY, TEXAS

TAX CERTIFICATE

The Bell County Tax Office, the taxing authority for all entities in Bell County, Texas, does hereby certify that there are currently no delinquent taxes due or owing on the property described by this plat.

Dated this 16th day of June, A.D. 2006.

BELL COUNTY TAX OFFICE
By: Henry T. Lewis

SPECIAL NOTE:
- THE FLOOD INSURANCE RATE MAP (FIRM), CITY OF KILLEEN, TEXAS, BELL COUNTY, COMMUNITY-PANEL NO. 480031 0009 B, DATED AUGUST 3, 1991, INDICATES THAT THIS TRACT LIES WITHIN ZONE C.
- MINIMUM FINISHED FLOOR ELEVATIONS FOR ALL STRUCTURES WITHIN THE PLATTED AREA SHOWN HEREBY SHALL BE 72.50 MSL.

REV.	DESCRIPTION	DATE	BY

PROJECT INFORMATION
TOTAL ACRES: 31.20
TOTAL BLOCKS: 3
TOTAL LOTS: 117

DRAFT DATE: MAY 2006
DRAWN BY: BC
DESIGNED BY: GN

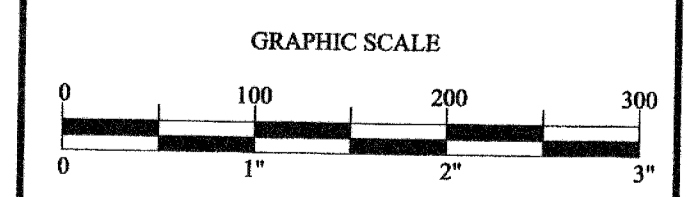

FINAL PLAT OF
SAVANNAH HEIGHTS, PHASE III
City of Killeen, Bell County, Texas

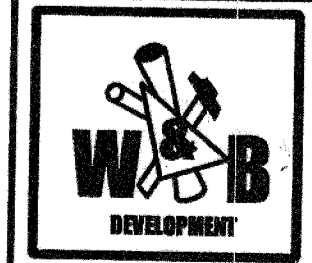

W & B DEVELOPMENT, LTD.
3000 ILLINOIS AVE
KILLEEN, TEXAS
PHONE: (254) 953-5353 FAX: (254) 953-5057

VERA & ASSOCIATES, L.C.
3707 SIERRA DR.
GEORGETOWN, TEXAS 78628
PHONE: (512) 864-9804 FAX (512) 864-7650

SHEET 1
OF 1