

RANCIER AVENUE -- F. M. 439 (120' R.O.W.)

BASE BEARING
S 88°15'00"E 537.57'

4710

TEXAS CONFERENCE ASSOCIATION
OF SEVENTH DAY ADVENTISTS
5.91 AC. VOL. 1535. PG. 240

NORTHVIEW ADDITION
CAB. C. SLIDE 67-B

LOT 1
BLOCK 1

WOODS HEALTH CARE
ADDITION
CAB. B. SLIDE 61-A

10' S.S.E.
VOL. 1366. PG. 147
VOL. 1366. PG. 679

AFFILIATED ADDITION
CAB. C. SLIDE 36-C

3 BLOCK 3
KILLEEN BUSINESS PARK
CAB. C. SLIDE 68-B

LOT 5, BLOCK 3
KILLEEN BUSINESS PARK SUBDIVISION
CAB. C., SLIDE 68-A+B

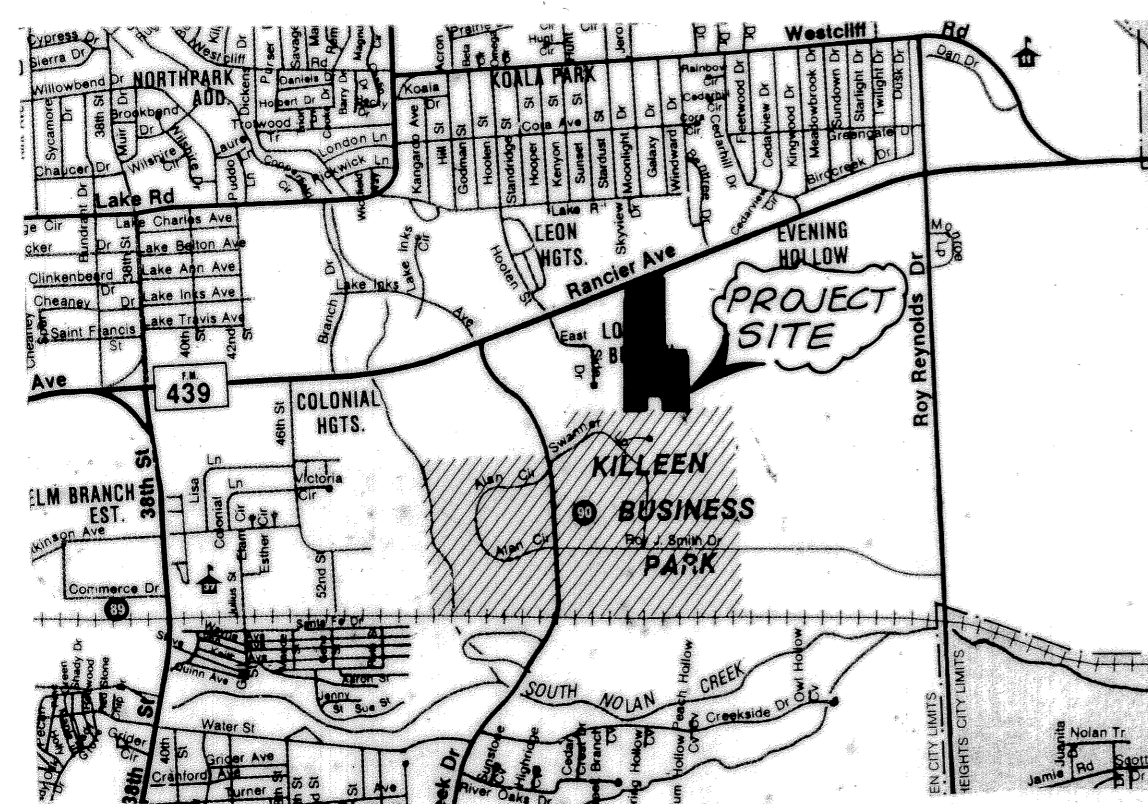

VICINITY MAP

NOT TO SCALE

- ⊙ CHAIN LINK FENCE POST FOUND
- 1/2" IRON ROD FOUND
- 3/8" IRON ROD FOUND
- (RECORD CALLS)

LEGEND



17.970 ACRES
ONE LOT

TAX CERTIFICATE

The Bell County Tax Appraisal District, the taxing authority for all entities in Bell County, Texas, does hereby certify that there are currently no delinquent taxes due or owing on the property described by this plat.

Dated this 14 Day of August, A.D. 2001.

BELL COUNTY TAX APPRAISAL DISTRICT

BY: Tenny Lewis

FINAL PLAT

REPLAT OF AND ADDITION TO
PEOPLE'S CHOICE SUBDIVISION
KILLEEN, BELL COUNTY, TEXAS

DEVELOPER/OWNER THE PEOPLES CHOICE WORSHIP CENTER, INC.				
HARMON & ASSOCIATES •• 105 W. VETERANS MEMORIAL BLVD KILLEEN, TEXAS (254) 634-8877				
DATE: MAY 2001	SCALE: SHOWN	REF: 1056-D, 232/1	DRAWN BY: BH	DWG. NO. 1879-D

KNOW ALL MEN BY THESE PRESENTS, that the People's Choice Pentecostal Holiness Church, Inc., (George Williams, Bishop), whose address is 5400 E. Veterans Memorial Blvd., Killeen, Texas, 76543, being the sole owners of that certain 17.970 acre tract, which is more fully described in the Dedication of REPLAT OF AND ADDITION TO PEOPLE'S CHOICE SUBDIVISION, as shown by the plat hereof, attached hereto, and made a part hereon, and approved by the City Council of the City of Killeen, Bell County, Texas, and People's Choice Pentecostal Holiness Church, Inc., does hereby adopt said REPLAT OF AND ADDITION TO PEOPLE'S CHOICE SUBDIVISION, as an Addition to the City of Killeen, Bell County, Texas, and hereby dedicates to said City all streets, avenues, road, drives and alleys shown on said plat, the same to be used as public thoroughfares and for the installation and maintenance of any and all public utilities when and as authorized by the City of Killeen. The utility easements shown on said plat are dedicated to said City for the installation and maintenance of any and all public utilities, which the City may install or permit to be installed or maintained.

George Williams
People's Choice Pentecostal Holiness Church, Inc.
George Williams, Bishop

BEFORE ME, the undersigned, a Notary Public in and for said County and State, on this day personally appeared George Williams known to me to be the person whose name is subscribed to the foregoing instrument and acknowledged to me that the same was the act of said George Williams and that he executed the same for the purpose and consideration therein expressed.

GIVEN UNDER MY HAND AND SEAL OF OFFICE, THIS 14th DAY OF Aug, 2001.

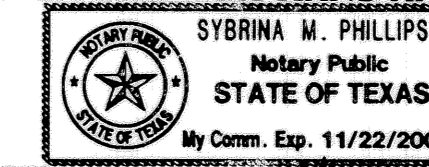

Sybrina M. Phillips
NOTARY PUBLIC FOR STATE OF TEXAS

APPROVED this 11th day of June, 2001, by the Planning Commission of the City of Killeen, Bell County, Texas.

James L. Bell Camela Smith
CHAIRMAN, PLANNING COMMISSION SECRETARY, PLANNING COMMISSION

APPROVED this 14th day of June, 2001, by the City Council of the City of Killeen, Bell County, Texas.

Maurice Jones Rula A. Mulla
MAYOR, CITY OF KILLEEN CITY SECRETARY

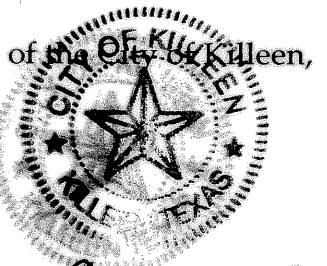

FILED FOR RECORD this 31st day of August, 2001, in Cabinet C, Slide 257-B
Plat Records of Bell County, Texas. Vol. 4476 Pg. 154

KNOW ALL MEN BY THESE PRESENTS, that I, Bruce M. Harmon, Registered Professional Land Surveyor, do hereby certify that I did prepare this plat from an actual and accurate survey of the land, that the corner monuments shown thereon were properly placed under my personal supervision in accordance with the subdivision regulations of the City of Killeen, Texas, and this subdivision is within the City Limits of Killeen, Bell County, Texas.

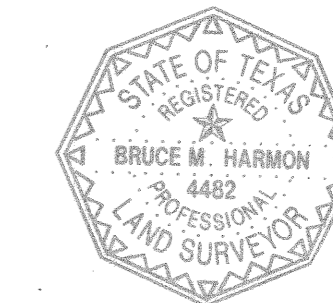

BMA
Bruce M. Harmon
Registered Professional
Land Surveyor No. 4482