

OLD 440 VILLAGE

BEING A REPLAT OF
A PORTION OF LOT 1, BLOCK 1 BURKE ADDITION AND
A PORTION OF DREAMLAND MOBILE HOME PARK

40.99 acres situated in the City of Killen, Bell County, Texas, and being out of the Thomas Robinett Survey, Abstract No. 686, and being a portion of Lot 1, Block 1, Burke Addition, a subdivision in Bell County, Texas according to the map or plat thereof recorded in Cabinet C, Slide 329 D, Plat Records Bell County, Texas, and being a portion of Dreamland Mobile Home Park, a subdivision in Bell County, Texas according to the map or plat thereof recorded in Cabinet C, Slide 104 C, Plat Records Bell County, Texas.

BEARINGS CITED HEREON BASED ON GRID NORTH,
TEXAS STATE PLANE COORDINATE SYSTEM,
SOUTH CENTRAL ZONE (4203 TX C), NAD 83 (CORS 96).
ALL DISTANCES SHOWN HEREON ARE SURFACE VALUES. GRID VALUES MAY BE DETERMINED BY
APPLYING A PROJECT COMBINED SCALE FACTOR (CSF) OF 0.99994.

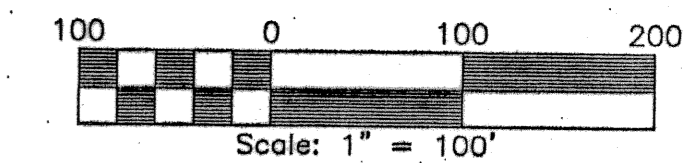
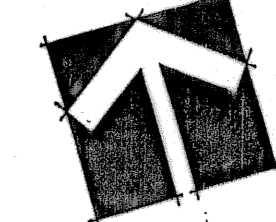

LEGEND	
⊙	3/8" IRON PIN FOUND UNLESS NOTED OTHERWISE
○	1/2" IRON PIN SET (YELLOW CAP "CS, LTD")
⊖	BLOCK NUMBER
BL	BUILDING SETBACK LINE
DE	DRAINAGE EASEMENT
UE	UTILITY EASEMENT
D.R.B.C.	DEED RECORDS BELL COUNTY
P.R.B.C.	PLAT RECORDS BELL COUNTY
O.P.R.R.P.B.C.	OFFICIAL PUBLIC RECORDS OF REAL PROPERTY BELL COUNTY

OWNER: Harris Acquisitions, L.L.C.
Wade S. Harris, C.E.O.
524 Carson Street
Dumas, Texas 79029

SURVEY: Thomas Robinett Survey, Abstract No. 686

NUMBER OF BLOCKS: 4

NUMBER OF LOTS: 143 (BLOCK 01 - 66 LOTS)
 (BLOCK 02 - 22 LOTS)
 (BLOCK 03 - 22 LOTS)
 (BLOCK 04 - 33 LOTS)

LINEAR FEET OF NEW STREETS: STEALTH LANE (70' ROW) 842.29 L.F.
 IVORY LANE (50' ROW) 874.4 L.F.
 CAVALRY LANE (50' ROW) 917.61 L.F.
 LOYAL LANE (50' ROW) 917.61 L.F.
 VANGUARD LANE (50' ROW) 917.61 L.F.
 CAMBRIDGE DRIVE (50' ROW) 144.05 L.F.
 CAMBRIDGE DRIVE (50' ROW) 2814.7 L.F.

DATE: JULY 31, 2006

SURVEYOR: CASTLEBERRY SURVEYING, LTD.
3613 WILLIAMS DRIVE, STE. 903
GEORGETOWN, TEXAS 78628
(512) 930-1600/(512) 930-9389 fax

ENGINEER: DUNLAP ENGINEERING, INC.
P.O. BOX 173
KILLEEN, TEXAS 76540-0173
(254) 702-7560/(254) 699-5788 fax

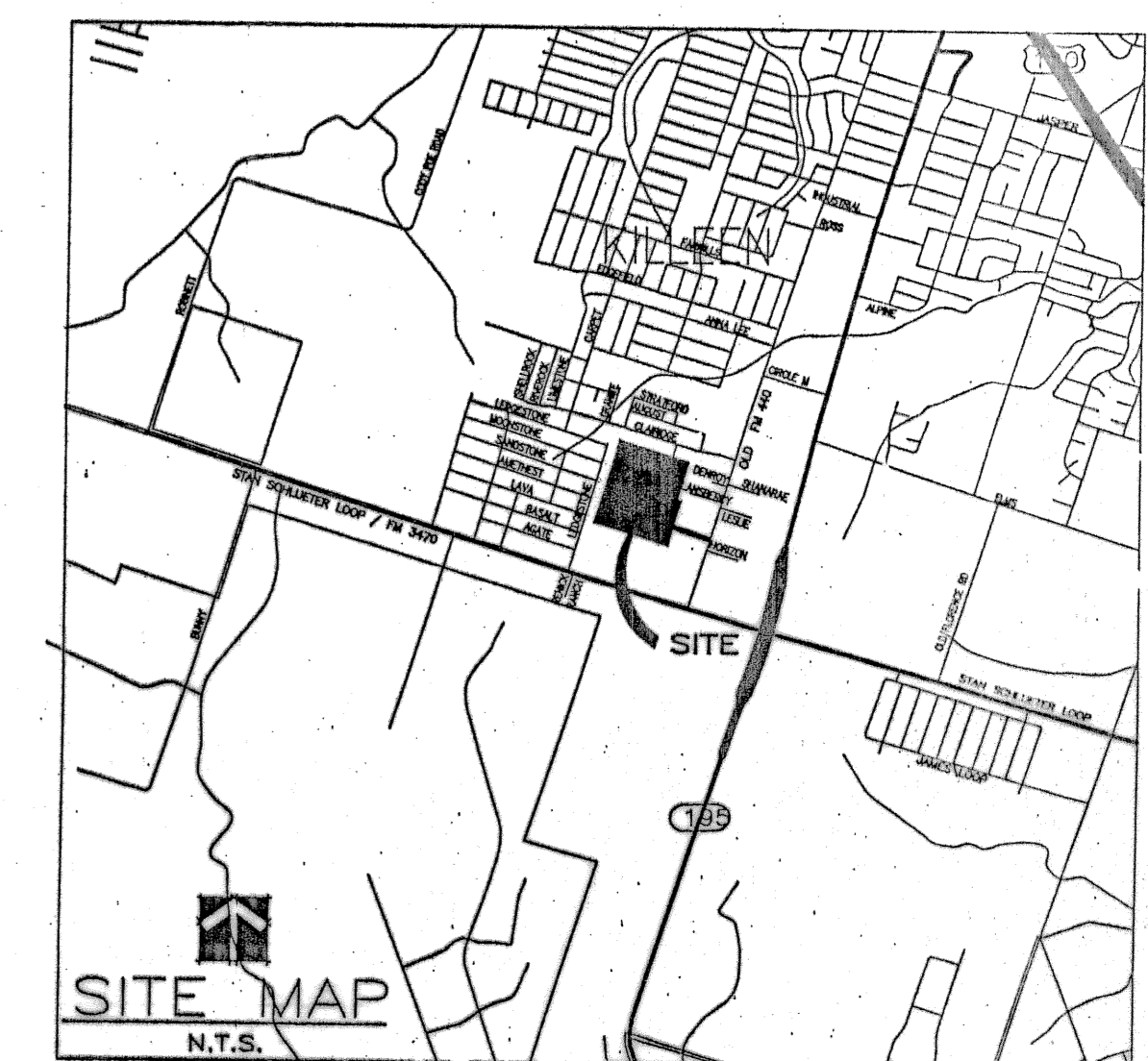

SITE MAP
N.T.S.

