



KNOW ALL MEN BY THESE PRESENTS, that Richard L. Piasta and wife, Sylvia J. Piasta, whose address is 704 Oakhill Drive, Killeen, Bell County, Texas, being the owner of Lots 1, 2 and part of Lot 3, Block 2, Northside Addition, being 0.314 acres out of the Hadden O'Neal Survey, Abstract No. 645, Bell County, Texas, shown by the plat hereof, attached hereto, and made a part hereof, and approved by the City Council of the City of Killeen, Bell County, Texas, and Richard L. Piasta and wife, Sylvia J. Piasta, does hereby adopt said Replat of Lots 1, 2 and part of Lot 3, Block 2, Northside Addition, to the City of Killeen, Bell County, Texas, for the purpose of selling lots and blocks of land with reference thereto and for all other purposes, do hereby dedicate to the City of Killeen, all streets, avenues, roads, drives and alleys shown on said Replat, the same to be used as public thoroughfares and for the installation and maintenance of public utilities when and as authorized by the City of Killeen, which said City may elect to install or permit to be installed or maintained.

WITNESS THE EXECUTION, this the 17 day of December, 1983.
 Richard L. Piasta Sylvia J. Piasta

X BEFORE ME THE UNDERSIGNED, a Notary Public in the State of Texas, on the day personally appeared Sylvia and Richard Piasta known to me to be the person whose names are subscribed to the foregoing instrument and acknowledged to me that they executed the same for the purpose and consideration therein expressed.

GIVEN UNDER MY HAND AND SEAL, of office this the 17 day of December, 1983.
 Patsy Irwin
 Notary Public in and for the State of Texas.

APPROVED THIS 3rd day of January, 1984, by the Planning Commission of the City of Killeen, Texas.
 [Signature]
 Chairman, Planning Commission

[Signature]
 Secretary, Planning Commission

APPROVED this 10th day of January, 1984, by the City Council of the City of Killeen, Texas.
 Mayor
 Attest: City Secretary

FILED FOR RECORD THIS 11th day of JANUARY, 1984, Bell County, Texas.
 Clerk A 334-D, Plat Records of Bell County, Texas. Vol. 1926 PG. 137

KNOW ALL MEN BY THESE PRESENTS, that G. L. Gishell, Registered Public Surveyor, do hereby certify that I prepared this plat from an actual and accurate survey of the land, that the corner monuments shown hereon were correctly placed under my personal supervision in accordance with the subdivision regulations of the City of Killeen, Texas.
 G. L. Gishell
 Registered Public Surveyor, No. 1602

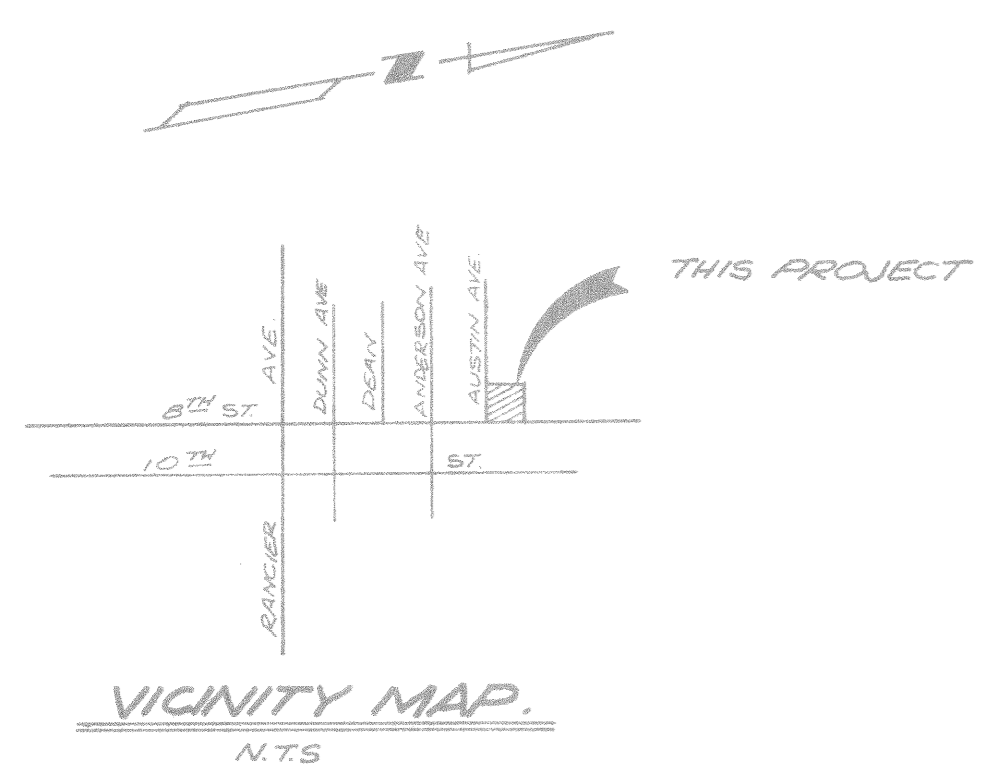

1 LOT
 0.314 ACRE

FINAL PLAT

REPLAT OF LOTS 1, 2 & PART OF LOT 3, BLOCK 2, NORTHSIDE ADDITION, KILLEEN, BELL COUNTY, TEXAS.

WATWOOD - MITCHELL, INC.
 ENGINEERING & SURVEYING
 Killeen, Texas Temple, Texas

DATE: SEP 30, '83	SCALE: 1" = 20'	DRAWN BY: EBE	REF. NO. 593/30	DWG. NO. 2000-D
----------------------	--------------------	------------------	--------------------	--------------------