

KNOW ALL MEN BY THESE PRESENT, that Marguerite Norman, whose address is 3800 Trimmer, Killen, Texas, being the sole owner of that certain 7.539 acres tract of land in Bell County, Texas, part of the G. W. Farris Survey, Abstract No. 306 and the Azra Webb Survey, Abstract 857, which is more fully described in the dedication of NORMAN COMMERCIAL SUBDIVISION as shown by the plat hereof, attached hereto, and made a part hereon, and approved by the City Council of the City of Killen, Bell County, Texas, and Marguerite Norman, does hereby adopt said NORMAN COMMERCIAL SUBDIVISION, as an addition to the City of Killen, Bell County, Texas, and hereby dedicates to said city all streets, avenues, roads, drives and alleys shown on said plat, the same to be used as public thoroughfares and for the installation and maintenance of public utilities when and as authorized by the City of Killen. The utility easements shown on said plat are dedicated to said city for the installation and maintenance of any and all public utilities, which the city may install or permit to be installed or maintained.

MARGUERITE NORMAN  
MARGUERITE NORMAN

BEFORE ME, the undersigned, a Notary Public in and for said County and State, on this day personally appeared Marguerite Norman, known to me to be the person whose name is subscribed to the foregoing instrument and acknowledged to me that the same was the act of said Marguerite Norman, and that she executed the same for the purpose and consideration therein expressed.

GIVEN UNDER MY HAND AND SEAL OF OFFICE, this 21<sup>st</sup> day of December, 1994 A.D.

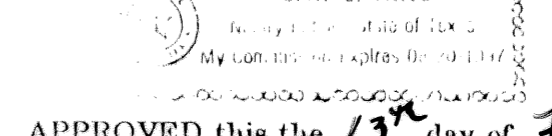

South C. Maxey  
NOTARY PUBLIC STATE OF TEXAS

APPROVED this the 13<sup>th</sup> day of February, 1995, by the Planning and Zoning Commission of the City of Killen, Bell County, Texas.

Chairman, Planning Commission

Secretary, Planning Commission

APPROVED this the 28<sup>th</sup> day of February, 1995, by the City Council of the City of Killen, Bell County, Texas.

Mayor, City of Killen

Attest: City Secretary

FILED FOR RECORD this 29<sup>th</sup> day of March, 1995 A.D., in Cabinet C, Slide 21-2, Plat Records of Bell County, Texas.

KNOW ALL MEN BY THESE PRESENTS,

That I, Gale E. Mitchell, Registered Professional Land Surveyor, do hereby certify that I did prepare this plat from an actual and accurate survey of the land, that the corner monuments shown hereon were properly placed under my personal supervision in accordance with the subdivision regulations of the City of Killen, Texas, and this subdivision is within the City Limits of Killen, Texas.

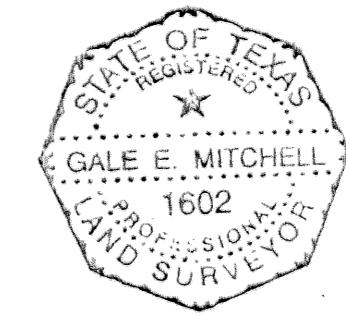

Gale E. Mitchell  
Registered Professional  
Land Surveyor, No. 1602

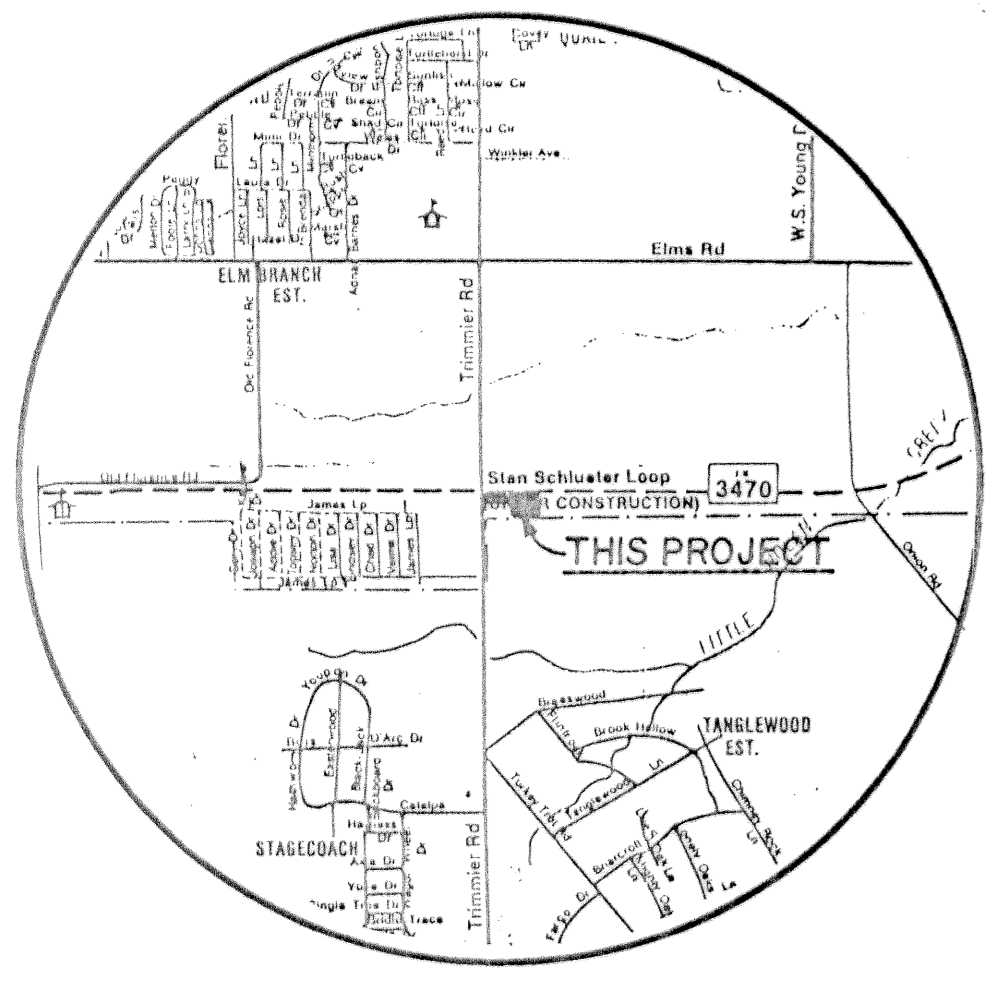

VICINITY MAP  
NOT TO SCALE

MITCHELL &  
ASSOCIATES  
KILLEEN, TEXAS

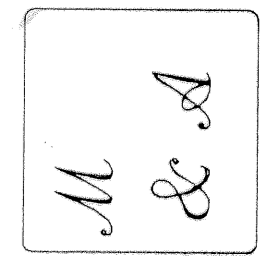

NORMAN COMMERCIAL SUBDIVISION  
7.539 ACRES PART OF THE G.W.FARRIS  
SURVEY A#306 AND THE AZRA WEBB SURVEY A#857  
KILLEEN, BELL COUNTY, TEXAS

FINAL PLAT

DGN BY S.D.  
DATE: 12/08/94  
SCALE 1"=100'

REF.:  
11020-C  
4054-B  
2856-D  
1053/24

7.539 AC  
DRAWING NO.  
11047-D