

WATER LINE NORTH SIDE AVE. 0



EXHIBIT 'B'	
APPROVED:	
LANDLORD:	
TENANT:	
MIDTOWN MALL SHOPPING CENTER KILLEEN, TEXAS	
DU BOSE KILLEEN PROPERTIES INC. BOX 11449 FORT WORTH TEXAS 76103	
TOTAL LEASABLE AREA	131,760 SF
TOTAL PARKING SPACES	683
TOTAL LAND AREA	2.51 ACRES
LOADING SPACES: 10x25 MIN.	
Woolworth's	4
BEALL'S	2
HEB	2
LEASABLE #1	1 EACH UNIT = 4
LEASABLE #2	1 EACH UNIT = 7

WATER & SEWER ENGINEER DEPT.

Checked and Approved
Ben Long
 City Engineer
 City of Killeen
 Date 6/6/68

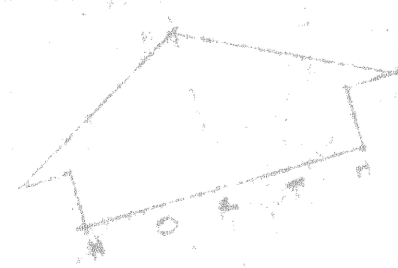
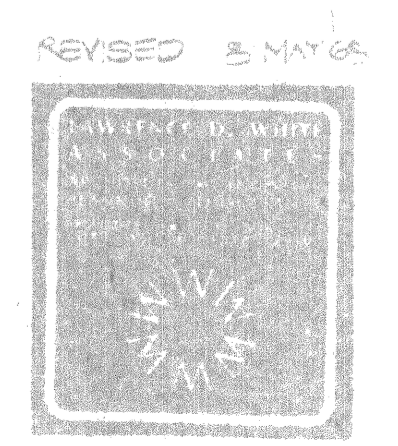

90'