

KNOW ALL MEN BY THESE PRESENTS, that William H. Sparks and Sammie J. Sparks, whose address is P.O. Box 934, Salado, Texas 76571, being the sole owners of that certain 1.921 tract of land in Bell County, Texas, part of the Nathan Halbert Survey, Abstract 389, which is more fully described in the dedication of MARRIOTT ADDITION, PHASE TWO, as shown by the plat hereof, attached hereto, and made a part hereon, and approved by the City Council of the City of Killeen, Bell County, Texas, does hereby adopt said MARRIOTT ADDITION, PHASE TWO, as an addition to the City of Killeen, Bell County, Texas, and hereby dedicates to said city all streets, avenues, roads, drives and alleys shown on said plat, the same to be used as public thoroughfares and for the installation and maintenance of public utilities when and as authorized by the City of Killeen. The utility easements shown on said plat are dedicated to said city for installation and maintenance of any and all public utilities which the city may install or permit to be installed or maintained.

William H. Sparks
William H. Sparks

Sammie J. Sparks
Sammie J. Sparks

STATE OF TEXAS
COUNTY OF BELL

This instrument was acknowledged before me on the 31 day of October, 2003 by William H. Sparks and Sammie J. Sparks.

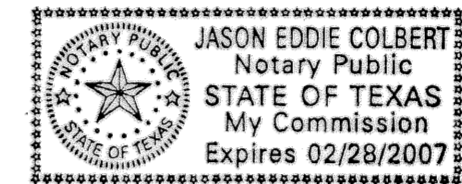

Jason E. Colbert
NOTARY PUBLIC, STATE OF TEXAS

Approved this 8th day of December 2003 by the Planning and Zoning Commission of the City of Killeen, Texas.

James T. Goff
Chairman, Planning and Zoning Commission
Randa Smith
Secretary, Planning and Zoning Commission

FILED FOR RECORD this 12th day of December, 2003 A.D.
Cabinet C, Slide 362 B, Plat Records of Bell County, Texas.
Dedication Instrument in Volume 5226, Page 123, Deed Records of Bell County, Texas.

KNOW ALL MEN BY THESE PRESENTS:

That I, A.W. Kessler, a Registered Professional Land Surveyor, do hereby certify that I prepared this plat from an actual and accurate survey of the land and that the perimeter corner monuments shown hereon were properly placed or found under my personal supervision, in accordance with the Subdivision and Property Development Regulations of the City of Killeen, Texas. This subdivision, MARRIOTT ADDITION, PHASE TWO, is located within the City Limits of Killeen, Texas.

A.W. Kessler 12-8-03
A.W. Kessler, RPLS (TX 1852)

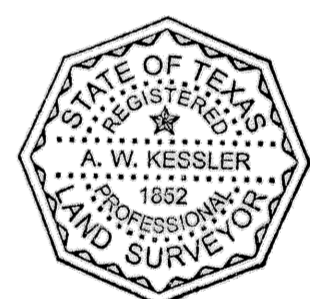

TAX CERTIFICATE

The Bell County Tax Appraisal District, the taxing authority for all entities in Bell County, Texas does hereby certify that there are currently no delinquent taxes due or owing on the property decrbed by this plat.

Dated this 10th day of December, 2003 A.D. Killeen, Bell County, Texas.
BELL COUNTY TAX APPRAISAL DISTRICT
By: Tenny T. Lewis

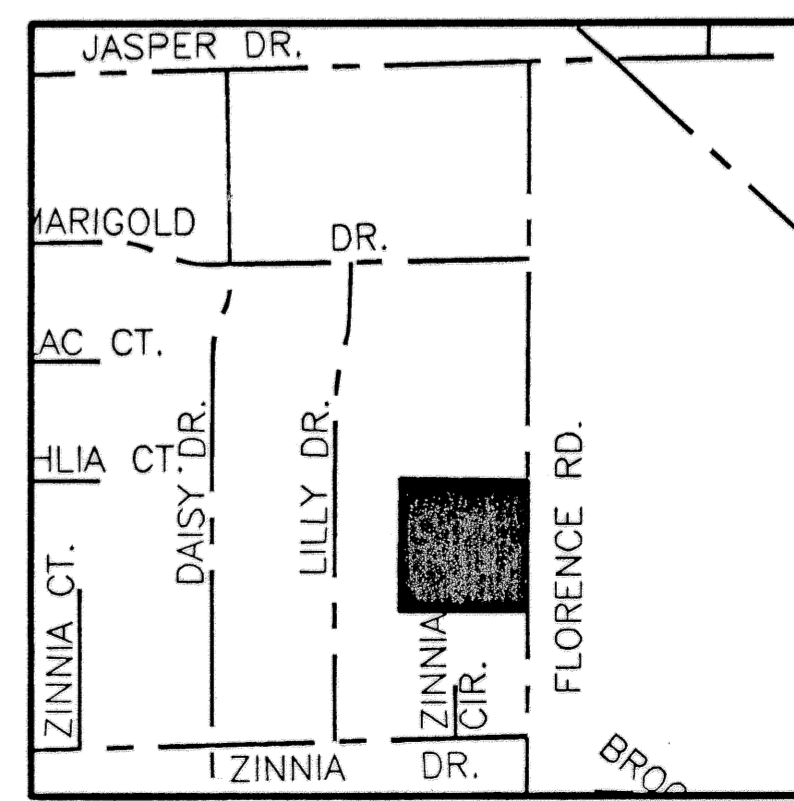

VICINITY MAP
N.T.S.

FINAL PLAT

MARRIOTT ADDITION
PHASE TWO
KILLEEN, BELL COUNTY, TEXAS

KILLEEN ENGINEERING
& SURVEYING, LTD.
2901 E. Stan Schlueter Loop
Killeen, Texas 76542
(254) 526-3981 (254) 526-4351 Fax

Project No.:	2003-063
Acres:	1.921
No. of Lots:	1
Scale:	1" = 100'
Date:	10/31/03
Design By:	JEC
Sheet No.:	