



INSET "A"
LEE HOTEL & PLAZA ADDITION
1"=100'

SEWER NOTE: EXISTING FACILITIES ARE ON SEPTIC TANK AND MAY REMAIN, SO LONG AS THE CURRENT SEPTIC TANK REMAINS FUNCTIONAL. CURRENT SEPTIC TANK SHALL NOT BE REPLACED OR MODIFIED AND ANY FUTURE FACILITIES MUST BE ON SANITARY SEWER.

KNOW ALL MEN BY THESE PRESENTS, that Young Won Lee and Yeon Ok Lee, whose address is 309 Carter Street, Killeen, Texas 76541, being the sole owners of that certain 4.759 acre tract of land in Bell County, Texas, out of the Southern Pacific Railroad Company Survey, Abstract 794, which is more fully described in the dedication of LEE HOTEL & PLAZA ADDITION, as shown by the plat hereof, attached hereto, and made a part hereof, and approved by the City Council of the City of Killeen, Bell County, Texas, does hereby adopt said LEE HOTEL & PLAZA ADDITION, as an addition to the City of Killeen, Bell County, Texas, and hereby dedicates to said city all streets, avenues, roads, drives and alleys shown on said plat, the same to be used as public thoroughfares and for the installation and maintenance of public utilities when and as authorized by the City of Killeen. The utility easements shown on said plat are dedicated to said city for installation and maintenance of any and all public utilities which the city may install or permit to be installed or maintained.

[Signature]
YOUNG WON LEE
[Signature]
YEON OK LEE

STATE OF TEXAS
COUNTY OF BELL
This instrument was acknowledged before me on the 17 day of August, 2005 by YOUNG WON LEE and YEON OK LEE

[Notary Seal]
C. ADAMS
Notary Public
STATE OF TEXAS
My Commission Expires 07/15/2008
[Signature]
NOTARY PUBLIC, STATE OF TEXAS

Approved this 26 day of September, 2005 by the Planning and Zoning Commission of the City of Killeen, Texas.

[Signature]
Chairman, Planning and Zoning Commission
[Signature]
Secretary, Planning and Zoning Commission

Approved this 11 day of October, 2005 by the City Council of the City of Killeen, Texas.

[Signature]
Mayor
[Signature]
City Secretary

FILED FOR RECORD this 26th day of October, 2005 A.D.
Cabinet D, Slide 79C, Plat Records of Bell County, Texas.
Dedication Instrument in Volume 5871, Page 058, Deed Records of Bell County, Texas.

KNOW ALL MEN BY THESE PRESENTS:
That I, Michelle E. Lee, a Registered Professional Land Surveyor, do hereby certify that I prepared this plat from an actual and accurate survey of the land and that the perimeter corner monuments shown hereon were properly placed or found under my supervision, in accordance with the Subdivision and Property Development Regulations of the City of Killeen, Texas. This subdivision, LEE PLAZA & HOTEL ADDITION, is located within the City Limits of Killeen, Texas.

[Signature]
Michelle E. Lee 9-13-05
Michelle E. Lee, RPLS (TX 5772)

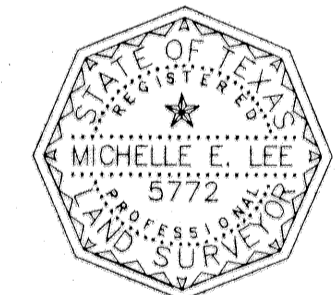

TAX CERTIFICATE
The Bell County Tax Appraisal District, the taxing authority for all entities in Bell County, Texas does hereby certify that there are currently no delinquent taxes due or owing on the property described by this plat.
Dated this 5th day of October, 2005 A.D. Killeen, Bell County, Texas.
BELL COUNTY TAX APPRAISAL DISTRICT
By: *[Signature]*

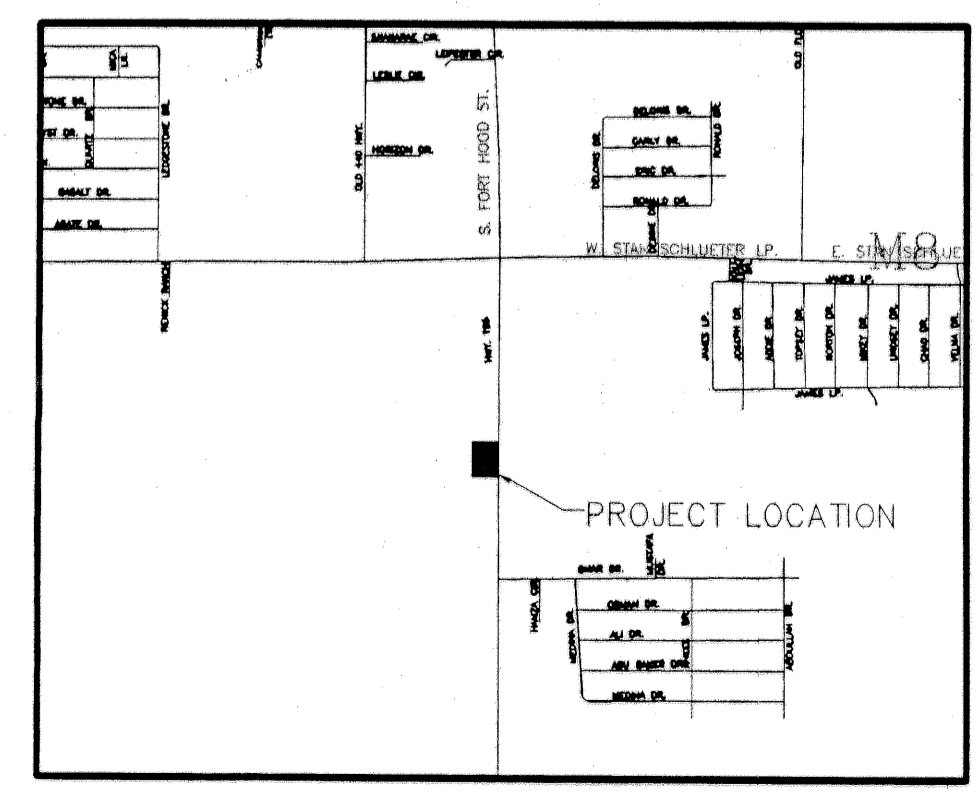

VICINITY MAP
N.T.S.

KILLEEN ENGINEERING & SURVEYING, LTD.
2901 E. Stan Schlueter Loop
Killeen, Texas 76542
(254) 526-3981 (254) 526-4351 Fax

LEE HOTEL & PLAZA ADDITION
KILLEEN, BELL COUNTY, TEXAS

FINAL PLAT

Project No.:	2005-046
Acres:	4.759
No. of Lots:	1
Scale:	1" = 50'
Date:	7/18/05
Design By:	MEL
Sheet No.:	1 OF 1