

D
113-D

D
113-D



PICKELSIMER, JESSIE MAE
VOL. 1025, PAGE 201

CANNON, JASON E.
VOL. 688, PAGE 602

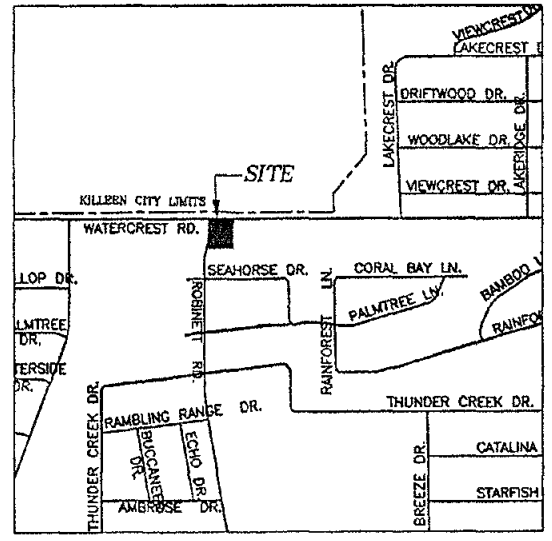

VICINITY MAP
N.T.S.

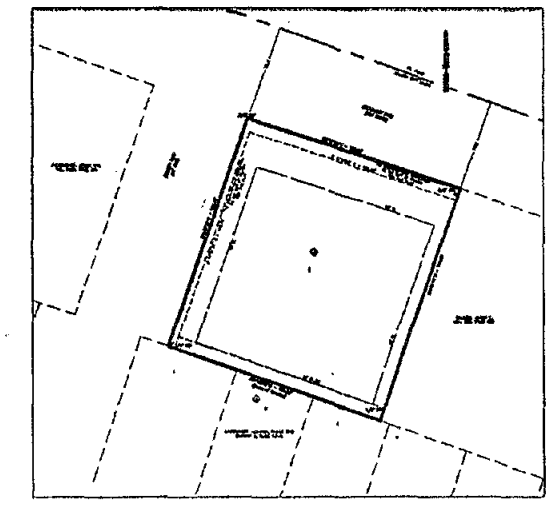

INSET "A"
Kim & Son Addition
1"=100'

KNOW ALL MEN BY THESE PRESENTS, that Young Bok Kim and Ki Sup Son, whose address is 2401 Southport Drive, Killeen, Texas 76542, being the sole owner of that 0.819 acre tract of land in Bell County, Texas, part of the Thomas Robinett Survey, Abstract No. 686, which is more fully described in the dedication of Kim & Son Addition, as shown by the plat hereof, attached hereto, and made a part hereon, and approved by the Planning and Zoning Commission of the City of Killeen, Bell County, Texas, does hereby adopt said Kim & Son Addition, as an addition to the City of Killeen, Bell County, Texas, and hereby dedicates to said city all streets, avenues, roads, drives and alleys shown on said plat, the same to be used as public thoroughfares and for the installation and maintenance of public utilities when and as authorized by the City of Killeen. The utility easements shown on said plat are dedicated to said city for installation and maintenance of any and all public utilities which the city may install or permit to be installed or maintained.

Young Bok Kim
Young Bok Kim
Ki Sup Son
Ki Sup Son

STATE OF TEXAS
COUNTY OF BELL

This instrument was acknowledged before me on the 28 day of March, 2006 by Young Bok Kim and Ki Sup Son.



Rebecca Adams
Notary Public, State of Texas

Approved this 10th day of April, 2006 by the Planning and Zoning Commission of the City of Killeen, Texas.

[Signature]
Chairman, Planning and Zoning Commission
[Signature]
Secretary, Planning and Zoning Commission

FILED FOR RECORD this 4 day of MAY, 2006 A.D.

Cabinet D, Slide 113-D Plat Records of Bell County, Texas.

Dedication instrument in Volume , Page , Deed Records of Bell County, Texas.

KNOW ALL MEN BY THESE PRESENTS:

That I, Michelle E. Lee, a Registered Professional Land Surveyor, do hereby certify that I prepared this plat from an actual and accurate survey of the land and that the perimeter corner monuments shown hereon were properly placed or found under my personal supervision, in accordance with the Subdivision Regulations of the City of Killeen, Texas. This subdivision, Kim & Son Addition, is located within the City Limits of Killeen, Texas.

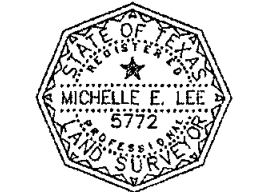

Michelle E. Lee 3-27-06
Michelle E. Lee, RPLS (TX 5772)

TAX CERTIFICATE

The Bell County Tax Appraisal District, the taxing authority for all entities in Bell County, Texas does hereby certify that there are currently no delinquent taxes due or owing on the property described by this plat.

Dated this 18th day of April, 2006 A.D.

BELL COUNTY TAX APPRAISAL DISTRICT

By: *Terry T. Lewis*

FINAL PLAT

KILLEEN ENGINEERING & SURVEYING, LTD.
2901 E. Stan Schlueter Loop
Killeen, Texas 76542
(254) 526-3981 (254) 526-4351 Fax

KIM & SON ADDITION

KILLEEN, BELL COUNTY, TEXAS

Project No.:	2006-012
Acres:	0.819
No. of Lots:	1
Scale:	1" = 20'
Date:	2/28/06
Design By:	CDD
Sheet No.:	1 OF 1