

RANCIER. AVE.

2299. TO
GILMER. ST

N 71° W 410.6'

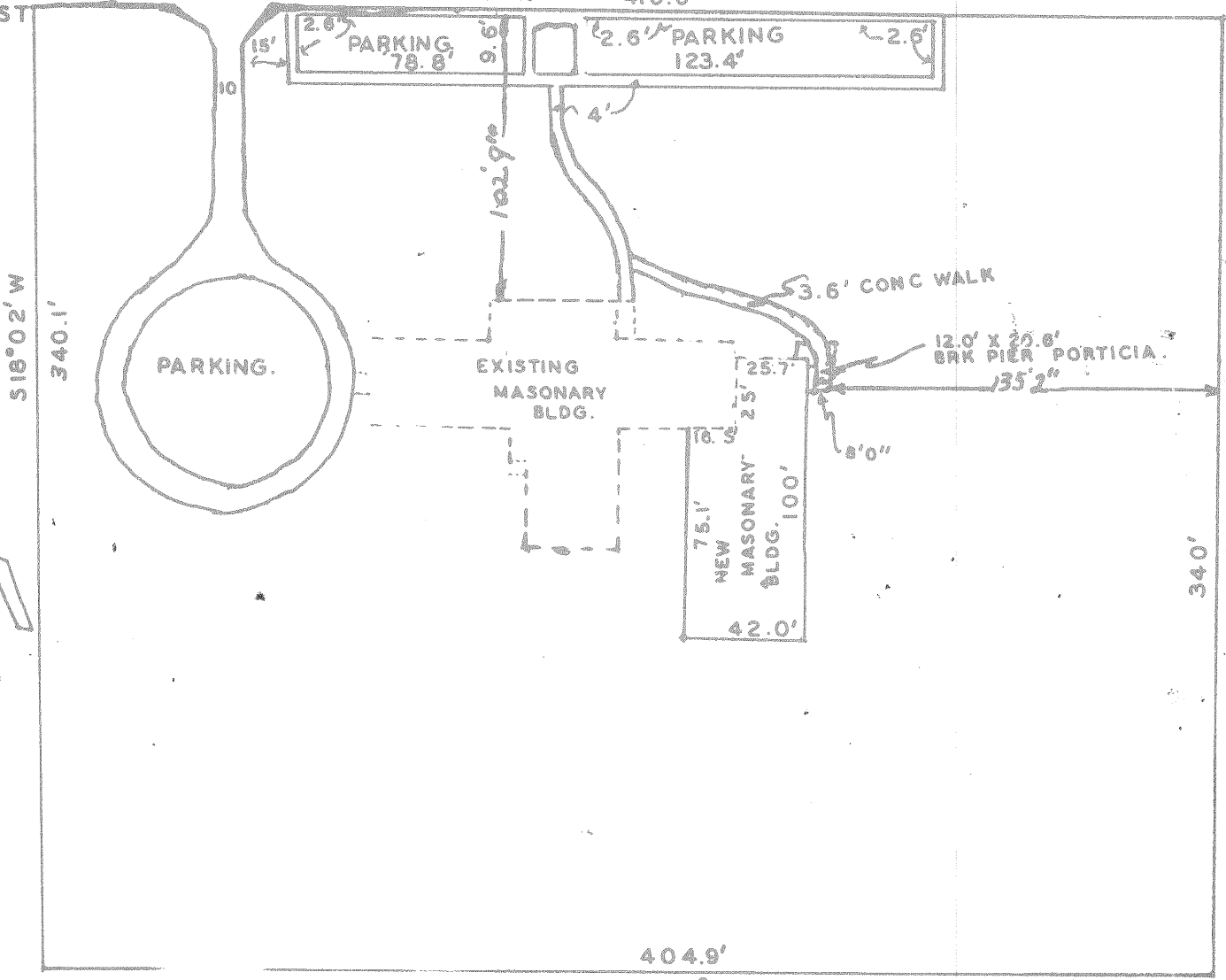

I, GLENN S. LEWIS, A REGISTERED PUBLIC SURVEYOR IN THE STATE OF TEXAS, DO HEREBY CERTIFY THAT THE ABOVE PLAT IS A SURVEY MADE ON THE GROUND, AND IS TRUE AND CORRECT TO THE BEST OF MY BELIEF AND KNOWLEDGE.

Glenn S. Lewis

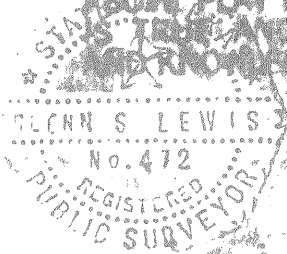

STANDARD SURVEYING CO.
P. O. Box 197, KILLEEN, TEXAS

Addition to
KILLEEN GENERAL HOSPITAL
Andy Craig
Part of Lot 1 Block B
Spofford Addition
City of Killeen
Bell County, Texas

September 11, 1958

Scale 1" = 60'