

APPROVED this the 12<sup>th</sup> day of December, 1988, by the Planning Commission of the City of Killeen, Bell County, Texas.

*Leonard G. Gullig* CHAIRMAN, PLANNING COMMISSION  
*Sharon L. Dunham* SECRETARY, PLANNING COMMISSION

APPROVED this the 27<sup>th</sup> day of December, 1988, by the City Council of the City of Killeen, Texas.

*David J. Goff* MAYOR, CITY OF KILLEEN  
*Harold J. Phipps* ATTEST: CITY SECRETARY

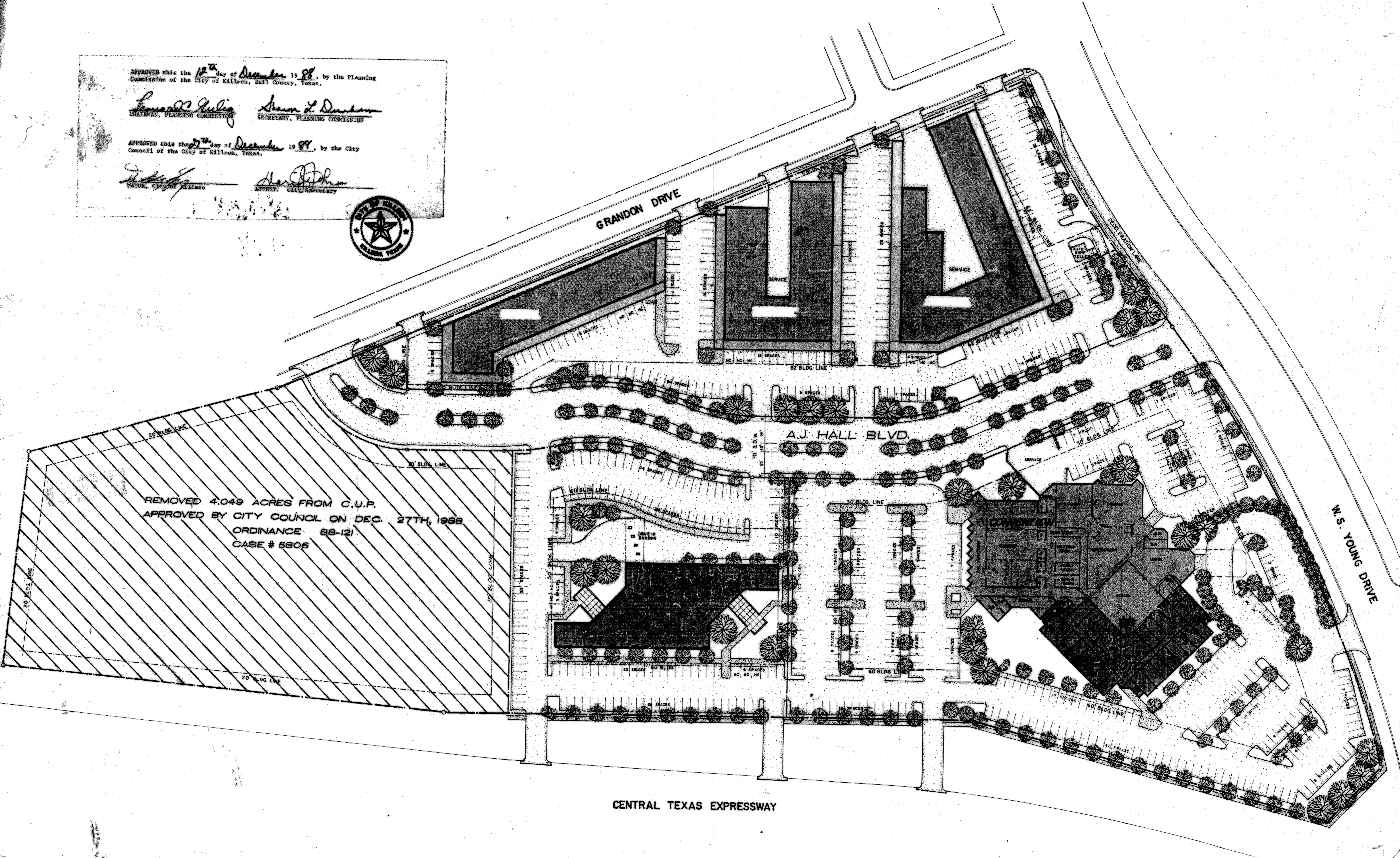
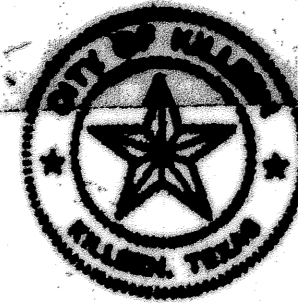

REMOVED 4.049 ACRES FROM C.U.P.  
 APPROVED BY CITY COUNCIL ON DEC. 27TH, 1988  
 ORDINANCE 88-121  
 CASE # 5806

CENTRAL TEXAS EXPRESSWAY

NOTE:  
 ALL SIGNS SHALL CONFORM TO CITY OF KILLEEN SIGN ORDINANCE.  
 ANY BUSINESS ALLOWED WITHIN THE B1 TO B4 ZONING.  
 ALL FUTURE RESTAURANT CLUBS MUST APPLY FOR RC-1 ZONING.

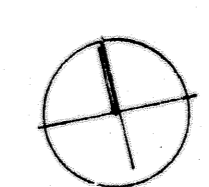

REVISED 3-6-84  
 AMENDED  
**COMMUNITY UNIT DEVELOPMENT PLAN**

**KILLEEN CENTRE**

KILLEEN, TEXAS

**PETER CORBIN PARCIANY**  
 ARCHITECT

MEMBER AMERICAN INSTITUTE OF ARCHITECTS  
 P.O. BOX 140 · LOMETA, TEXAS 76085 · 812-702-8602

DATE: 2-17-84  
 COMM. NO.: 366  
 SHEET NO.: P3

SCALE: 1" = 10'-0"