

KNOW ALL MEN BY THESE PRESENTS, that Barr Physical Therapy, P.C., whose address is 1102 Winkler Avenue, Killeen, Texas 76542, being the sole owner of that 2.342 acre tract of land in Bell County, Texas, part of the W. H. Cole Survey, Abstract No. 201, which is more fully described in the dedication of KIDZ THERAPEZE ADDITION, BEING A REPLAT OF LOT 1, BLOCK 1, CLAYTON WINKLER ADDITION AND 1.344 ACRES OUT OF THE W. H. COLE SURVEY, ABSTRACT NO. 201, as shown by the plat hereof, attached hereto, and made a part hereon, and approved by the City Council of the City of Killeen, Bell County, Texas, does hereby adopt said KIDZ THERAPEZE ADDITION, BEING A REPLAT OF LOT 1, BLOCK 1, CLAYTON WINKLER ADDITION AND 1.344 ACRES OUT OF THE W. H. COLE SURVEY, ABSTRACT NO. 201, as an addition to the City of Killeen, Bell County, Texas, and hereby dedicates to said city all streets, avenues, roads, drives and alleys shown on said plat, the same to be used as public thoroughfares and for the installation and the maintenance of public utilities when and as authorized by the City of Killeen. The utility easements shown on said plat are dedicated to said city for installation and maintenance of any and all public utilities which the city may install or permit to be installed or maintained.

For: Barr Physical Therapy, P.C.

*Kelly Barr*  
Kelly Barr, Director

STATE OF TEXAS  
COUNTY OF BELL

This instrument was acknowledged before me on the 27th day of January, 2009 by Kelly Barr.

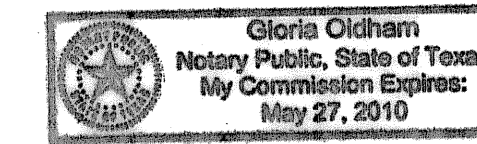

*Gloria Oldham*  
Notary Public, State of Texas

Approved this 9th day of February, 2009, by the Planning and Zoning Commission of the City of Killeen, Texas.

*John E. Cole*  
Chairman, Planning and Zoning Commission  
*Mike Harker*  
Secretary, Planning and Zoning Commission

Approved this 23 day of February, 2009 by the City Council of the City of Killeen, Texas.

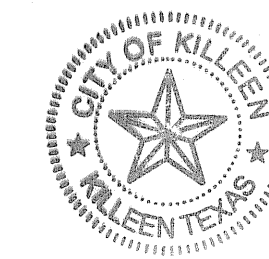

*Timothy S. Blawieck*  
Mayor  
*Paula W. Martin*  
City Secretary

FILED FOR RECORD this 20th day of March, 2009 A.D.

Cabinet D, Slide 262-B, Plat Records of Bell County, Texas.

Dedication Instrument in Instrument No. 2009-00009815, Deed Records of Bell County, Texas.

KNOW ALL MEN BY THESE PRESENTS:

That I, Michelle E. Lee, a Registered Professional Land Surveyor, do hereby certify that I prepared this plat from an actual and accurate survey of the land and that the perimeter corner monuments shown hereon were properly placed or found under my personal supervision, in accordance with the Subdivision Regulations of the City of Killeen, Texas. This subdivision, KIDZ THERAPEZE ADDITION, BEING A REPLAT OF LOT 1, BLOCK 1, CLAYTON WINKLER ADDITION AND 1.344 ACRES OUT OF THE W. H. COLE SURVEY, ABSTRACT NO. 201, is located within the City Limits of Killeen, Texas.

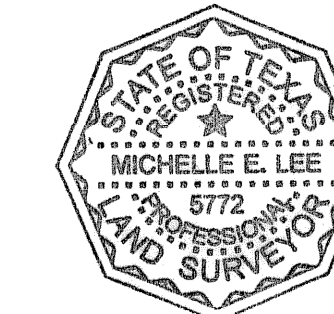

*Michelle E. Lee* 1-27-09  
Michelle E. Lee, RPLS (TX 5772)

TAX CERTIFICATE

The Bell County Tax Appraisal District, the taxing authority for all entities in Bell County, Texas does hereby certify that there are currently no delinquent taxes due or owing on the property described by this plat.

Dated this 30th day of March, 2009 A.D.

BELL COUNTY TAX APPRAISAL DISTRICT  
By: *Terry D. Lewis*

**KILLEEN ENGINEERING & SURVEYING, LTD.**

2901 E. Stan Schlueter Loop  
Killeen, Texas 76542  
(254) 526-3981 (254) 526-4351 Fax

FINAL PLAT

**KIDZ THERAPEZE ADDITION**  
BEING A REPLAT OF LOT 1, BLOCK 1, CLAYTON WINKLER ADDITION  
AND 1.344 ACRES OUT OF W. H. COLE SURVEY, ABSTRACT NO. 201  
KILLEEN, BELL COUNTY, TEXAS

Project No.:	2008-052
Acres:	2.342
No. of Lots:	1
Scale:	1" = 50'
Date:	01/09/09
Design By:	MEL/CDD
Sheet No.:	1 OF 1