

KNOW ALL MEN BY THESE PRESENTS, that Chantz Investment Inc., whose address is PO Box 1183, Killeen, Texas 76540 being the sole owner of that certain 5.702 acre tract of land in Bell County, Texas, part of the G.W. Farris Survey, Abstract No. 306 which is more fully described in the dedication of **JAMESWAY PHASE 5 BEING A REPLAT OF A PART OF LOT 1, BLOCK 1, JAMESWAY ADDITION PHASE ONE** as shown by the plat hereof, attached hereto, and made a part hereon, and approved by the City Council of the City of Killeen, Bell County, Texas, and Chantz Investment Inc., does hereby adopt said **JAMESWAY PHASE 5 BEING A REPLAT OF A PART OF LOT 1, BLOCK 1, JAMESWAY ADDITION PHASE ONE**, as an addition to the City of Killeen, Bell County, Texas, and hereby dedicates to said city all streets, avenues, roads, drives and alleys shown on said plat, the same to be used as public thoroughfares and for the installation and maintenance of public utilities when and as authorized by the City of Killeen. The utility easements shown on said plat are dedicated to said city for the installation and maintenance of any and all public utilities, which the city may install or permit to be installed or maintained.

WITNESSES the execution hereof, on this 1st day of April, 2005.

FOR: Chantz Investment Inc.
[Signature]
 William E. Hickman, President

Before me, the undersigned authority, on this day personally appeared William E. Hickman known to me to be the person whose name is subscribed to the foregoing instrument. It has been acknowledged to me that he executed the foregoing instrument as the President of Chantz Investment Inc., owner of the property described hereon.

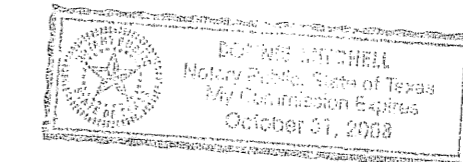

[Signature]
 Donnie Mitchell
 NOTARY PUBLIC STATE OF TEXAS
 My Commission Expires: 10-31-08

APPROVED this the 9th day of May, 2005, by the Planning and Zoning Commission of the City of Killeen, Bell County, Texas.

[Signature]
 CHAIRMAN, PLANNING COMMISSION
[Signature]
 SECRETARY, PLANNING COMMISSION

APPROVED this the 24 day of May, 2005, by the City Council of the City of Killeen, Bell County, Texas.

[Signature]
 MAYOR, CITY OF KILLEEN
[Signature]
 ATTEST: CITY SECRETARY

FILED FOR RECORD this 21 day of June, 2005, in Cabinet D, Slide 59C. Plat Records of Bell County, Texas. Vol 5738 pg 711

KNOW ALL MEN BY THESE PRESENTS,

That I, Gary W. Mitchell, Registered Professional Land Surveyor, do hereby certify that I did prepare this plat from an actual and accurate survey of the land, that the corner monuments shown hereon were properly placed under my personal supervision in accordance with the subdivision regulations of the City of Killeen, Texas, and this subdivision is within the City Limits of Killeen, Texas.

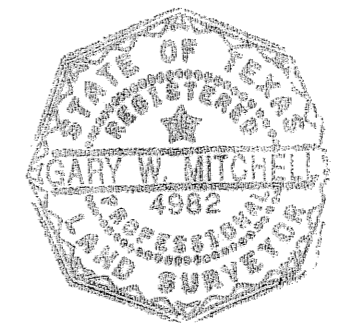

[Signature]
 Gary W. Mitchell
 Registered Professional
 Land Surveyor, No. 4982.

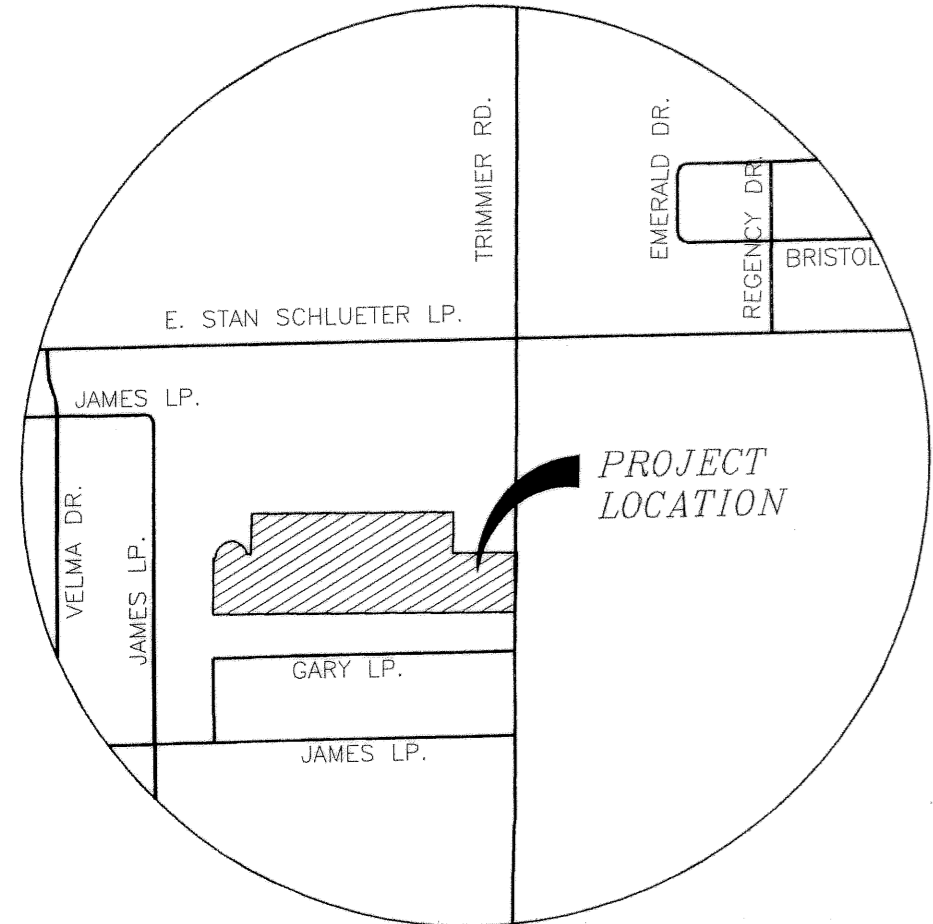

LINE	LENGTH	BEARING	PLAT CALLS
L1	20.00	S18°28'50"W	N/A
L2	5.70	S71°31'10"E	N/A
L3	170.00	N18°50'21"E	N18°49'31"E
L4	180.04	S19°39'14"W	S19°19'25"W
L5	200.01	S71°31'10"E	N/A
L6	59.60	S18°28'50"W	N/A
L7	60.42	S19°50'33"W	S19°56'11"W

CURVE	LENGTH	RADIUS	LONG CHORD	CHORD DIST.	DELTA	TANGENT
C1	147.01	50.00	S77°17'16"E	99.49	168°27'47"	494.95

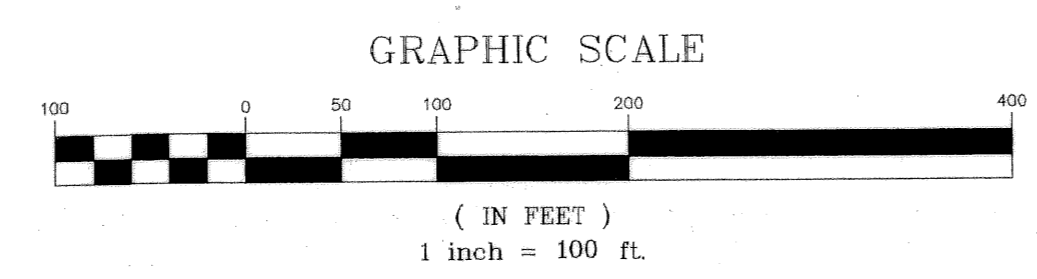

The Bell County Tax Appraisal District, the taxing authority for all entities in Bell County, Texas does hereby certify that there are currently no delinquent taxes due or owing on the property described by this plat.
 Dated this 16th day of May, A.D. 2005
 BELL COUNTY TAX APPRAISAL DISTRICT
 BY: *[Signature]*

No.	DATE	REVISIONS
1	4/14/05	ADDRESS CITY COMMENTS: ML

JAMESWAY PHASE 5
BEING A REPLAT OF A PART OF LOT 1, BLOCK 1, JAMESWAY ADDITION PHASE ONE
KILLEEN, BELL COUNTY, TEXAS
FINAL PLAT

MITCHELL & ASSOCIATES, INC.
 ENGINEERING & SURVEYING
 102 N. COLLEGE STREET
 KILLEEN, TEXAS 76541
 PHONE: (254) 634-5541
 FAX: (254) 634-2141