

Q CURVE DATA
 $\Delta = 40^{\circ}38'24''$
 $R = 239.84'$
 $T = 88.81'$
 $L.C. = 170.12'$

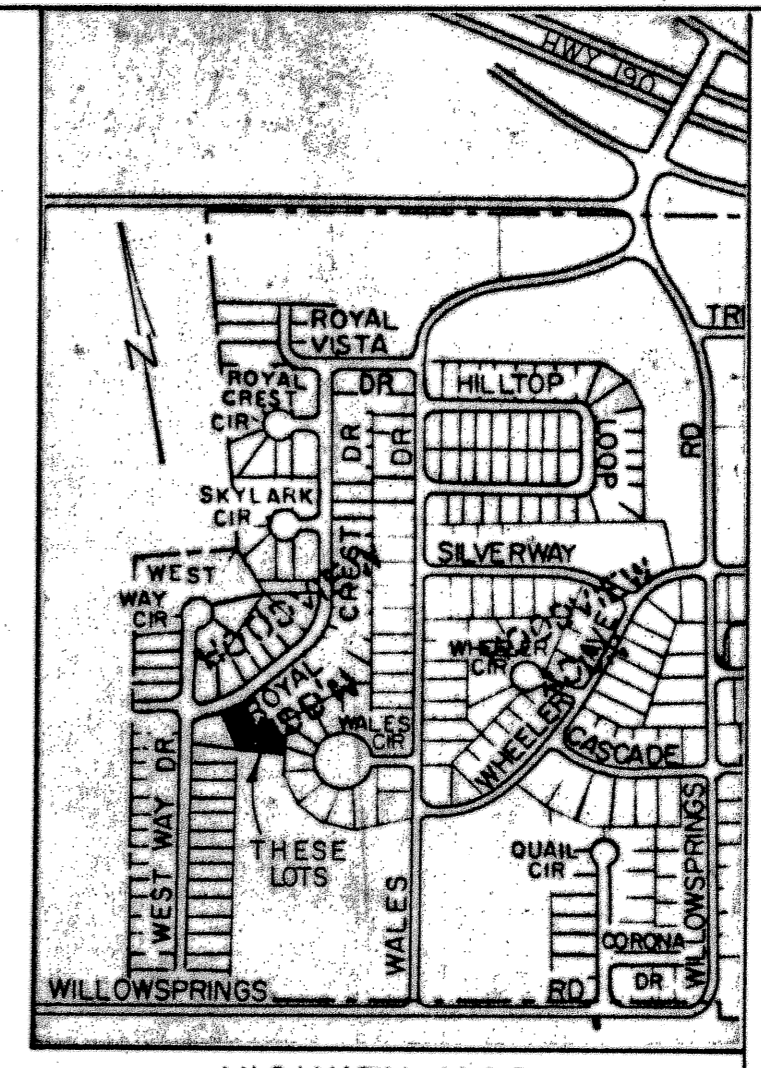

KNOW ALL MEN BY THESE PRESENTS, that C. L. R. Development, Inc., acting through its duly authorized officer, C. L. Reeves, President, being the sole owner of LOTS 31, 32, AND 33, BLOCK TWO, Heritage Home Addition, of record in Cabinet A, Slide 66C and 36D, DEED RECORDS, Bell County, Texas, does hereby replat said lots into lots and blocks as shown by the plat hereof, for the purpose of selling lots and blocks of land with reference thereto and for all other purposes, and does hereby dedicate to the City of Killen all streets, avenues, and easements shown on said plat, the same to be used as public thoroughfares and for the installation and maintenance of public utilities when and as authorized by the City of Killen, Texas.

C. L. Reeves
 C. L. Reeves, President
 1903 East Oltorf, Austin, Texas

Before me, the undersigned, a Notary Public in and for said County and State, on this day personally appeared C. L. Reeves, known to me to be the person and officer whose name is subscribed to the foregoing instrument and acknowledged to me that the same was the act of the said C. L. R. Development, Inc., a corporation, and that they executed the same as the act of such corporation for the purposes and consideration therein expressed and in the capacity therein stated.

Given under my hand and seal, this the 10th day of May, 1983.

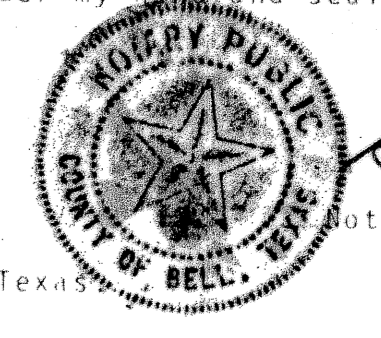

Sub Brady
 Sub Brady, Notary Public in and for Bell County, Texas

KNOW ALL MEN BY THESE PRESENTS, that I, Carl B. Pearson, Registered Professional Engineer, do hereby certify that I prepared this plat from an actual and accurate survey of the land and that the corner monuments shown thereon were properly placed under my personal supervision in accordance with the Subdivision Regulations of the City of Killen, Texas.

IN WITNESS WHEREOF, my hand and seal, this the 10th day of May, 1983.

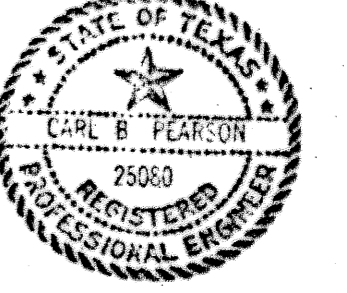

Carl B. Pearson
 Carl B. Pearson, P.E.

STATE OF TEXAS
 COUNTY OF BELL

KNOW ALL MEN BY THESE PRESENTS, that I, Carl B. Pearson, Registered Professional Engineer, do hereby certify that this plat is within the City Limits of the City of Killen, Bell County, Texas.



Carl B. Pearson
 Carl B. Pearson, P.E.

Approved this the 7th day of June, 1983, by the Planning Commission of the City of Killen, Texas.

John E. Howell
 Chairman, Planning Commission

Joyce M. Stafford
 Secretary, Planning Commission

Approved this the 14th day of June, 1983, by the City Council of the City of Killen, Texas.

Al C. C. C.
 Mayor

Dwanda Estep
 Attest: City Secretary

Filed for record this the 15 day of June, 1983, in Plat Book A, Page 99-A, and Deed Records Book 1865, Page 633, DEED RECORDS, Bell County, Texas.

FINAL PLAT
 LOTS - 31A & 32A
 BLOCK - TWO
 A REPLAT OF
 LOTS - 31, 32, & 33
 BLOCK - TWO
 HERITAGE HOME ADDITION

C.L.R. DEVELOPMENT, INC.
 Temple Civil Engineering

0.3197 ACRES
 2 LOTS

