

YONG KWON CHANG AND
HYO SUK CHANG
(5951/112)

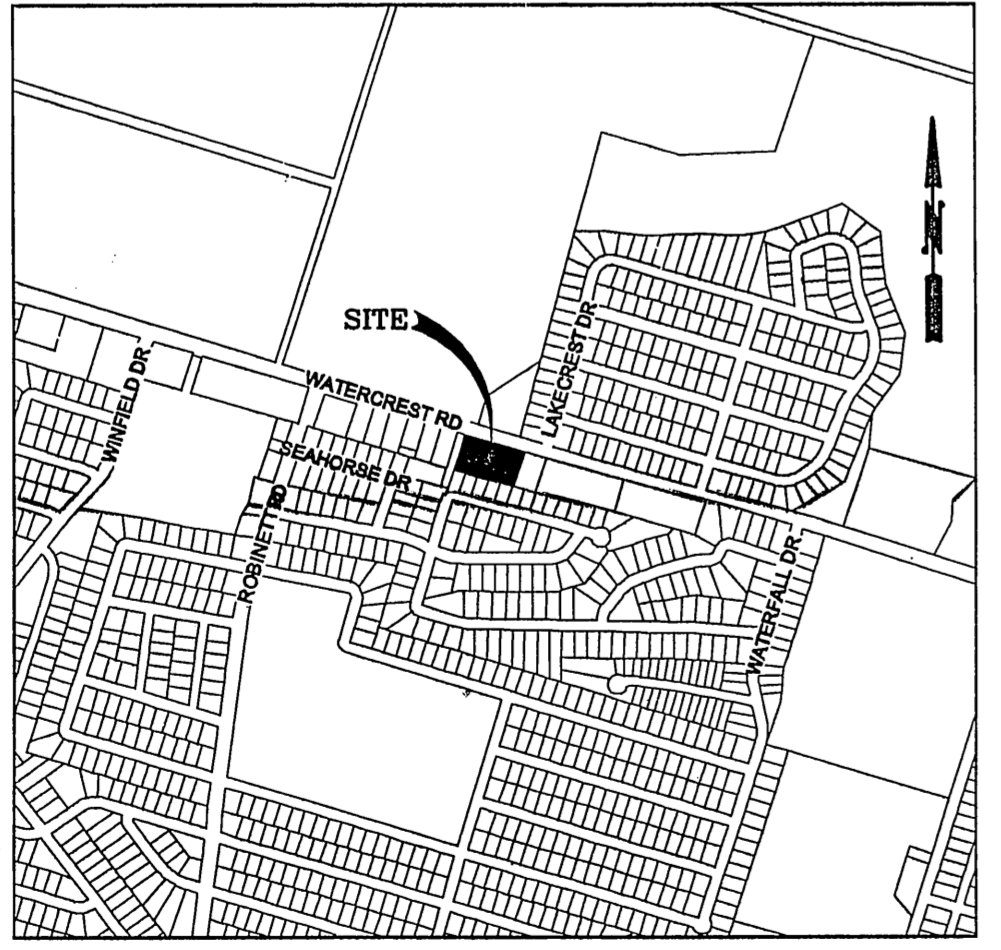
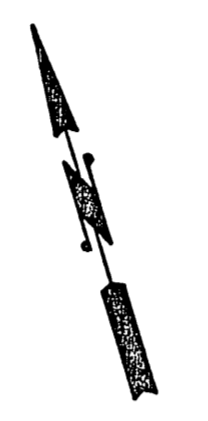

VICINITY MAP
N.T.S.

KNOW ALL MEN BY THESE PRESENTS, that In Ok Halliburton, whose address is 2502 Silverhill Drive, Killeen, Texas 76543, being the sole owner of that 1.515 acre tract of land in Bell County, Texas, part of the Thomas Robinett Survey Abstract No. 686, which is more fully described in the dedication of HALLIBURTON ADDITION, as shown by the plat hereto, attached hereto, and made a part hereof, and approved by the Planning and Zoning Commission of the City of Killeen, Bell County, Texas, does hereby adopt said HALLIBURTON ADDITION, as an addition to the City of Killeen, Bell County, Texas, and hereby dedicates to said city all streets, avenues, roads, drives and alleys shown on said plat, the same to be used as public thoroughfares and for the installation and maintenance of public utilities when and as authorized by the City of Killeen. The utility easements shown on said plat are dedicated to said city for installation and maintenance of any and all public utilities which the city may install or permit to be installed or maintained.

Ok Halliburton
In Ok Halliburton

STATE OF TEXAS
COUNTY OF BELL

This instrument was acknowledged before me on the 10 day of January, 2010 by In Ok Halliburton.

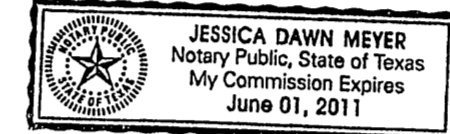

Jessica Dawn Meyer
Notary Public, State of Texas

Approved this 22nd day of February, 2010, by the Planning and Zoning Commission of the City of Killeen, Texas.

John F. Feltz
Chairman, Planning and Zoning Commission

Picki Hanken
Secretary, Planning and Zoning Commission

FILED FOR RECORD this 12th day of March, 2010 A.D.

Cabinet D, Slide 290-A Plat Records of Bell County, Texas.

Dedication Instrument in Instrument No. 2010-00009334 Deed Records of Bell County, Texas.

KNOW ALL MEN BY THESE PRESENTS:

That I, Michelle E. Lee, a Registered Professional Land Surveyor, do hereby certify that I prepared this plat from an actual and accurate survey of the land and that the perimeter corner monuments shown hereon were properly placed or found under my personal supervision, in accordance with the Subdivision Regulations of the City of Killeen, Texas. This subdivision, HALLIBURTON ADDITION, is located within the City Limits of Killeen, Texas.



Michelle E. Lee
Michelle E. Lee, RPLS (TX 5772)

TAX CERTIFICATE

The Bell County Tax Appraisal District, the taxing authority for all entities in Bell County, Texas does hereby certify that there are currently no delinquent taxes due or owing on the property described by this plat.

Dated this 10th day of February, 2010 A.D.

BELL COUNTY TAX APPRAISAL DISTRICT

By: *Tenny T. Lewis*

Note:

- The existing onsite sanitary sewer facility within the platted boundary of the Halliburton Addition that served the previous development shall, when abandoned or taken out of service, be closed in accordance with all applicable state and local onsite sanitary sewer facility regulations.

**KILLEEN ENGINEERING
& SURVEYING, LTD.**
TBPB REGISTRATION NO. 4200 TBPB REGISTRATION NO. 100144-00
2901 E. Stan Schlueter Loop
Killeen, Texas 76542
(254) 526-3981 (254) 526-4351 Fax

FINAL PLAT
HALLIBURTON ADDITION
KILLEEN, BELL COUNTY, TEXAS

Project No.:	2009-049
Scale:	1" = 30'
Acres:	1.515
No. of Lots:	1
Date:	02/09/2010
Design By:	JCM / MEL
Sheet No.:	1 OF 1