

**CURVE DATA**

NO.	INNER	€	OUTER	NO.	INNER	€	OUTER
1	43-18-33	43-18-33	43-18-33	6	18-57-37	18-57-37	18-57-37
R	171.82	201.82	231.82	R	389.82	419.82	449.82
T	68.82	80.82	91.82	T	64.82	70.82	75.82
L	129.82	152.82	174.82	L	128.82	138.82	148.82
C	126.82	148.82	170.82	C	128.82	138.82	147.82
2	32-06-54	43-18-33	32-59-27	6	29-57-47	41-26-05	41-26-05
R	106.82	136.82	166.82	R	300.82	330.82	360.82
T	31.82	54.82	49.82	T	80.82	105.82	130.82
L	60.82	103.82	96.82	L	157.82	239.82	260.82
C	59.82	100.82	94.82	C	155.82	233.82	255.82
3	29-36-18	29-36-18	29-36-18	7	43-18-33	43-18-33	43-18-33
R	234.82	264.82	294.82	R	70.82	100.82	130.82
T	62.82	70.82	77.82	T	68.82	40.82	51.82
L	121.82	136.82	152.82	L	23.82	70.82	98.82
C	100.82	135.82	150.82	C	52.82	70.82	96.82
4	62-38-09	62-38-09	62-38-09				
R	49.82	79.82	109.82				
T	30.82	48.82	66.82				
L	53.82	86.82	119.82				
C	51.82	82.82	113.82				

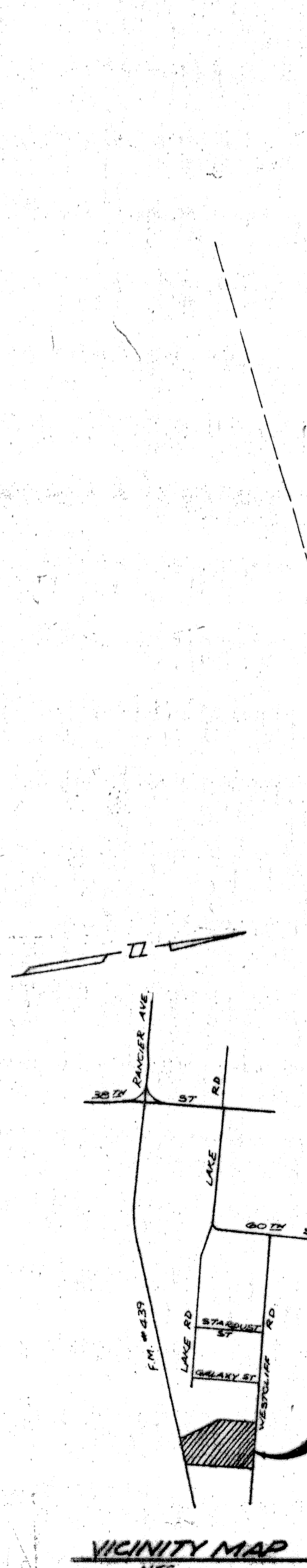

BEFORE ALL MEN BY THESE PRESENTS, that we, Kenneth Kirkpatrick, Dorothy Kirkpatrick, address in P.O. Box 244, Killean, Bell County, Texas, being owner of that certain 74.475 acre tract of land out of the Kinder Survey, Abstract No. 912, which is more fully described in the plat of Evening Hollow Addn, 3rd Extension, Killean, Bell County, Texas, for the purpose of selling lots and blocks of land in reference thereto and for all other purposes do hereby dedicate to the City of Killean, all streets, avenues, roads, drives, as shown on said plat the same to be used as public thoroughfares for the installation and maintenance of public utilities, when authorized by the City of Killean. The utility easements of said are dedicated to the City of Killean for installation and maintenance of any and all public utilities which the City may or permit to be installed or maintained.

WITNESS the execution here this 7th day of October, 1983.

Kenneth Kirkpatrick  
Dorothy Kirkpatrick  
Jackie Lynn Kirkpatrick

I, Shela Jones, Notary Public in and for said State of Texas, on this day personally appeared Kenneth Kirkpatrick, Dorothy Kirkpatrick, Jackie Lynn Kirkpatrick, known to me to be the persons whose names are subscribed to the instrument and acknowledged to me that the same was the act and deed of said persons, and that they executed the same for the purposes and consideration therein expressed.

WITNESS my hand and seal, this the 7th day of October, 1983, A.D.

Shela Jones  
Notary Public in and for Bell County, Texas

APPROVED this 18th day of November, 1983, by the Planning Commission for the City of Killean, Bell County, Texas.

Len Schwertner  
Chairman, Planning Commission

Len Schwertner  
Secretary, Planning Commission

APPROVED this 18th day of November, 1983, by the City of Killean, Texas.

Jason D. Adams  
Mayor Pro-Tem

Donna Stutz  
Attest: City Secretary

Filed for Record this 18th day of November, 1983, at 11:00 A.M. in Book 330-A, Page 117 of the Public Records of Bell County, Texas.

Gale F. Mitchell  
Registered Public Surveyor, No. 182

BEFORE ALL MEN BY THESE PRESENTS, that I, Gale F. Mitchell, Registered Public Surveyor, do certify that I did cause to be surveyed and ground the above described tract of land and that the corners shown thereon were properly placed in accordance with the subdivisions of the City of Killean, Texas, and this subdivision within the City Limits of Killean.



**FINAL PLAT**

**EVENING HOLLOW ADDN 3RD EXTENSION**

KILLEAN, BELL COUNTY, TEXAS

**WATWOOD-MITCHELL, INC.**  
ENGINEERING & SURVEYING

Killean, Texas

DATE: AUG. 19, '83 SCALE: 1"=100' DRAWN BY: EBE REF. NO.: 1907-D