

INSET 'A'
Elms Run Commercial West
1"=100'



KNOW ALL MEN BY THESE PRESENTS, that The True Vine, L.C., a Texas Limited Liability Company, whose address is 416 North Gray Street, Killeen, Texas 76541, being the sole owner of that 1.660 acre tract of land in Bell County, Texas, part of the Azra Webb Survey, Abstract No. 857, which is more fully described in the dedication of Elms Run Commercial West, as shown by the plat hereof, attached hereto, and made a part hereon, and approved by the Planning and Zoning Commission of the City of Killeen, Bell County, Texas, does hereby adopt said Elms Run Commercial West, as an addition to the City of Killeen, Bell County, Texas, and hereby dedicates to said city all streets, avenues, roads, drives and alleys shown on said plat, the same to be used as public thoroughfares and for the installation and maintenance of public utilities when and as authorized by the City of Killeen. The utility easements shown on said plat are dedicated to said city for installation and maintenance of any and all public utilities which the city may install or permit to be installed or maintained.

For: The True Vine, L.C., a Texas Limited Liability Company

Austin Ruiz
Austin Ruiz, President

STATE OF TEXAS
COUNTY OF BELL

This instrument was acknowledged before me on the 9th day of June, 2006 by Austin Ruiz.

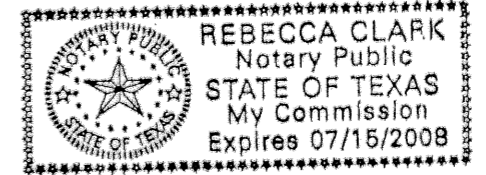

Rebecca Clark
Notary Public, State of Texas

Approved this 10th day of July, 2006, by the Planning and Zoning Commission of the City of Killeen, Texas.

John Fredrick
Chairman, Planning and Zoning Commission

Picki Kember
Secretary, Planning and Zoning Commission

FILED FOR RECORD this 4th day of August, 2006 A.D.

Cabinet D, Slide 1289, Plat Records of Bell County, Texas.

Dedication Instrument in Volume 6151, Page 096, Deed Records of Bell County, Texas.

KNOW ALL MEN BY THESE PRESENTS:

That I, Michelle E. Lee, a Registered Professional Land Surveyor, do hereby certify that I prepared this plat from an actual and accurate survey of the land and that the perimeter corner monuments shown hereon were properly placed or found under my personal supervision, in accordance with the Subdivision Regulations of the City of Killeen, Texas. This subdivision, Elms Run Commercial West, is located within the City Limits of Killeen, Texas.

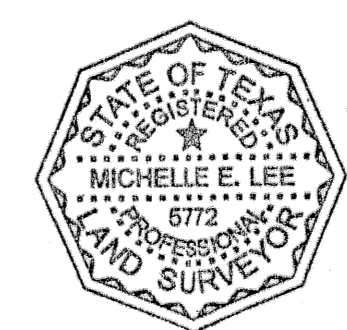

Michelle E. Lee
Michelle E. Lee, RPLS (TX 5772)

TAX CERTIFICATE

The Bell County Tax Appraisal District, the taxing authority for all entities in Bell County, Texas does hereby certify that there are currently no delinquent taxes due or owing on the property described by this plat.

Dated this 10th day of July, 2006 A.D.

BELL COUNTY TAX APPRAISAL DISTRICT

By: *George G. Lewis*

FINAL PLAT

**KILLEEN ENGINEERING
& SURVEYING, LTD.**
2901 E. Stan Schlueter Loop
Killeen, Texas 76542
(254) 526-3981 (254) 526-4351 Fax

**ELMS RUN COMMERCIAL WEST
KILLEEN, BELL COUNTY, TEXAS**

Project No.:	2006-037
Acres:	1.660
No. of Lots:	1
Scale:	1" = 40'
Date:	5/19/2006
Design By:	MEL/CDD
Sheet No.:	1 OF 1