

Ab	Inner	Q	Outer		
1	53-27-09 158.18 56.35 109.86 108.21	35-22-19 218.16 69.87 134.69 132.66	35-22-19 249.16 79.13 153.21 150.78		
	2	54-36-21 163.72 84.51 156.05 150.22	54-36-21 193.72 100.00 184.68 177.72	54-36-21 223.72 115.00 213.22 205.88	
		3	35-23-39 172.71 57.02 110.40 108.63	35-23-39 203.71 65.00 125.05 123.05	35-23-39 223.71 72.98 141.23 139.05
			4	35-23-37 257.02 82.02 150.20 156.20	35-23-37 282.02 90.00 174.24 171.48

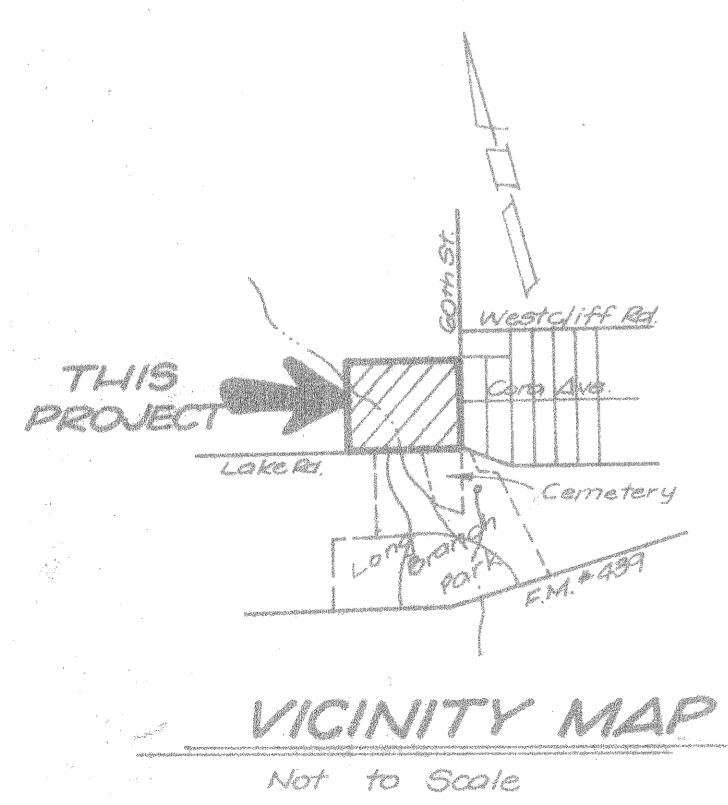

13  
12  
11  
10  
9  
8  
7  
6  
5  
4  
3  
2  
1

1000 S  
Right of Way  
of Block 2  
5 (2)

1000 S  
Right of Way  
of Block 2  
5 (2)

1000 S  
Right of Way  
of Block 2  
5 (2)

KNOW ALL MEN BY THESE PRESENTS, that Gary Purser and Curtis Chafin, whose address is 907 Root Avenue, Killeen, Bell County, Texas, being the sole owners of that certain 37.406 acre tract of land out of the A. Dickson Survey, Abstract No. 266, which is more fully described in the plat of Copperfield Addn., Killeen, Bell County, Texas, for the purpose of selling lots and blocks of land with reference thereto and for all other purposes do hereby dedicate to the City of Killeen, all streets, avenues, roads, drives and alleys shown on said plat the same to be used as public thoroughfares for the installation and maintenance of public utilities, when and authorized by the City of Killeen. The utility easements on said plat are dedicated to the City of Killeen for maintenance of any and all public utilities which the City may install or permit to be installed and maintained.

WITNESS the execution this the 24th day of February, 1983, A. D.

Gary Purser  
Curtis Chafin

BEFORE Me the undersigned, a Notary Public in and for said County and State on this day personally appeared \_\_\_\_\_ and \_\_\_\_\_ known to me to be the persons whose names are subscribed to the foregoing instrument and acknowledged to me that the same was the act of said Gary Purser and Curtis Chafin and that they executed the same for the purpose and consideration therein expressed.

GIVEN Under my hand and seal, this the 24th day of February, 1983.

Notary Public in and for Bell County, Texas

APPROVED this 24th day of February, 1983, by the Planning Commission of the City of Killeen, Bell County, Texas.

Chairman, Planning Commission  
Secretary, Planning Commission

APPROVED this 24th day of February, 1983, by the City Council of the City of Killeen, Bell County, Texas.

Mayor  
City Secretary

Filed for record this 24th day of February, 1983, Bell County, Texas, in Cabinet A, Slide 339-A, VOL. 1933 PG. 565

KNOW ALL MEN BY THESE PRESENTS, that I, Gale E. Mitchell, Registered Public Surveyor, do hereby certify that I prepared this survey from an actual and accurate survey of the land and that the corner monuments shown were properly placed under my personal supervision in accordance with the subdivision regulations of the City of Killeen, Bell County, Texas, and this subdivision is within the City Limits of Killeen.

Gale E. Mitchell  
Registered Public Surveyor, No. 1602

Final Plat

**COPPERFIELD ADDN.**  
A. DICKSON SURVEY, ABSTRACT 266  
KILLEEN, BELL COUNTY, TEXAS

**WATWOOD - MITCHELL, INC.**  
ENGINEERING & SURVEYING

Killeen, Texas Temple, Texas

DATE: April, '83 SCALE: 1"=100' DRAWN BY: L.L. REF. NO. 1602 DIV. NO. 1602

37.406 Acres  
146 Lots