

- 1/2" Iron Pin Set
- ⊙ 3/8" Iron Pin Found
- ⊙ 1" Iron Pipe Found
- Overhead Electric
- Overhead Telephone
- Overhead Cable

The State of Texas:
County of Bell :

KNOW ALL MEN BY THESE PRESENTS: that Wol Sun Dobson, being the sole owner of the certain land shown hereon, being Lots 10, 11, and 12, Block 8, Camp Addition in Bell County, Texas, as described in a deed dated February 9, 2007, and recorded in Vol. 6352, Page 346, of the Official Public Records of Bell County, Texas, do hereby join, approve and consent to all dedications and plat note requirements shown hereon. I do hereby approve recordation of this subdivision plat and dedicate to the public use forever any easements and roads that are shown hereon. This subdivision is to be known as "CAMP ADDITION AMENDED", being an amended plat of lots 10, 11, and 12, Block 8, Camp Addition.

I do hereby adopt said plat as an addition to Bell County, Texas, and for the purpose of selling lots and blocks of land with reference thereto, and for all other purposes do hereby dedicate to the County of Bell, all streets, avenues, roads, drives and alleys shown on said plat, the same to be used as public thoroughfares and for the installation and maintenance of public utilities, when and as authorized by the County of Bell. The utility easements shown on said plat are dedicated to the public, for the installation and maintenance of any and all public utilities, which the County may elect to install and maintain or permit to be installed and maintained.

Easements are reserved as shown on the plat, plus required onto all lots in this subdivision, for the constuction and perpetual maintenance of poles, wires, and fixtures for electric and telephone service, and to trim any trees which may interfere or threaten to interfere with the maintenance of such lines with right of ingress to and egress from across said premises to employees of said utilities. Said easements are also to extend along any owner's side and rear property lines in case of fractional lots.

It is understood and agreed that it shall not be considered a violation of the provisions of the easement if the wires or cables carried by such pole lines pass over a portion of said lots as long as such lines do not hinder the buildings on any lots in this subdivision.

All public roadways and easements as shown on this plat are free of liens.

WITNESS the execution hereof, on this 10 day of October, 2007.

Wol Sun Dobson Wol Sun Dobson
Wol Sun Dobson

Before me, the undersigned Notary Public in and for the State of Texas, on this date personally appeared Wol Sun Dobson, known to me to be the person whose name is subscribed to the foregoing instrument, and acknowledged to me that he executed the foregoing instrument as the owner of the property described hereon.

Anna Betty Stibbe
Notary Public State of Texas

My Commission Expires: 08/01/2009

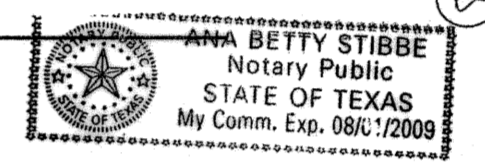

① not signed before me
② signed before me

APPROVED this the 17th day of December, 2007, A.D., by the Planning and Zoning Commission of the City of Killeen, Bell County, Texas.

John Fink
Chairman, Planning and Zoning Commission

Fishi Hansen
Secretary, Planning and Zoning Commission

KNOW ALL MEN BY THESE PRESENTS: That I, Paul W. Maples, Registered Professional Land Surveyor, do hereby certify that I did prepare this plat from an actual and accurate survey of the land, and that the corner monuments shown hereon were properly placed under my personal supervision, in accordance with the Subdivision Regulations of the County of Bell, Texas, and this subdivision is within the County Limits of Bell County, Texas.

Paul W. Maples

Paul W. Maples, RPLS
Texas Registration No. 5043
P.O. Box 893
Lampasas, TX 76550



The Bell County Tax Appraisal District, the taxing authority for all entities in Bell County, Texas does hereby certify that there are currently no delinquent taxes due or owing on the property described by this plat.

Dated this 20 day of December, 2007.

BELL COUNTY TAX APPRAISAL DISTRICT

By: Melissa Matos

FILED FOR RECORD this 22nd day of JANUARY, 2008, in Plat Cabinet D, Slide 207-C, Plat Records of Bell County, Texas. Dedication recorded in Instrument No. 2008-00002912 Official Public Records of Bell County, Texas.

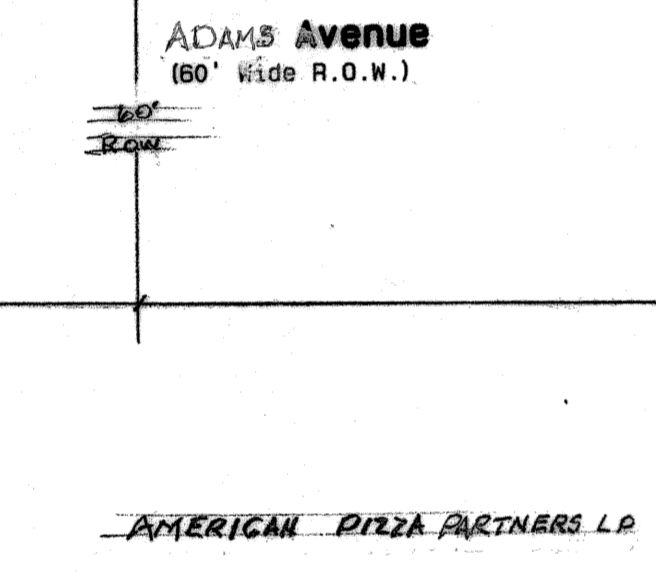

CAMP ADDITION AMENDED
Scale 1" = 100'

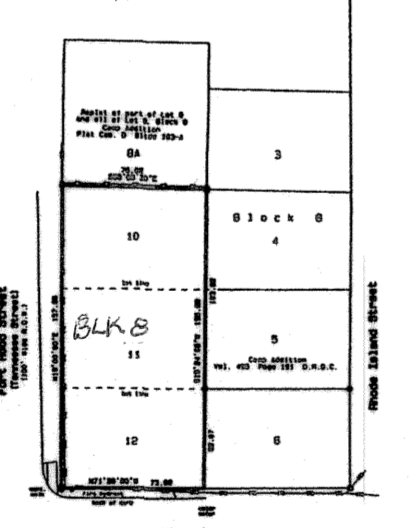

CAMP ADDITION
Scale 1" = 100'

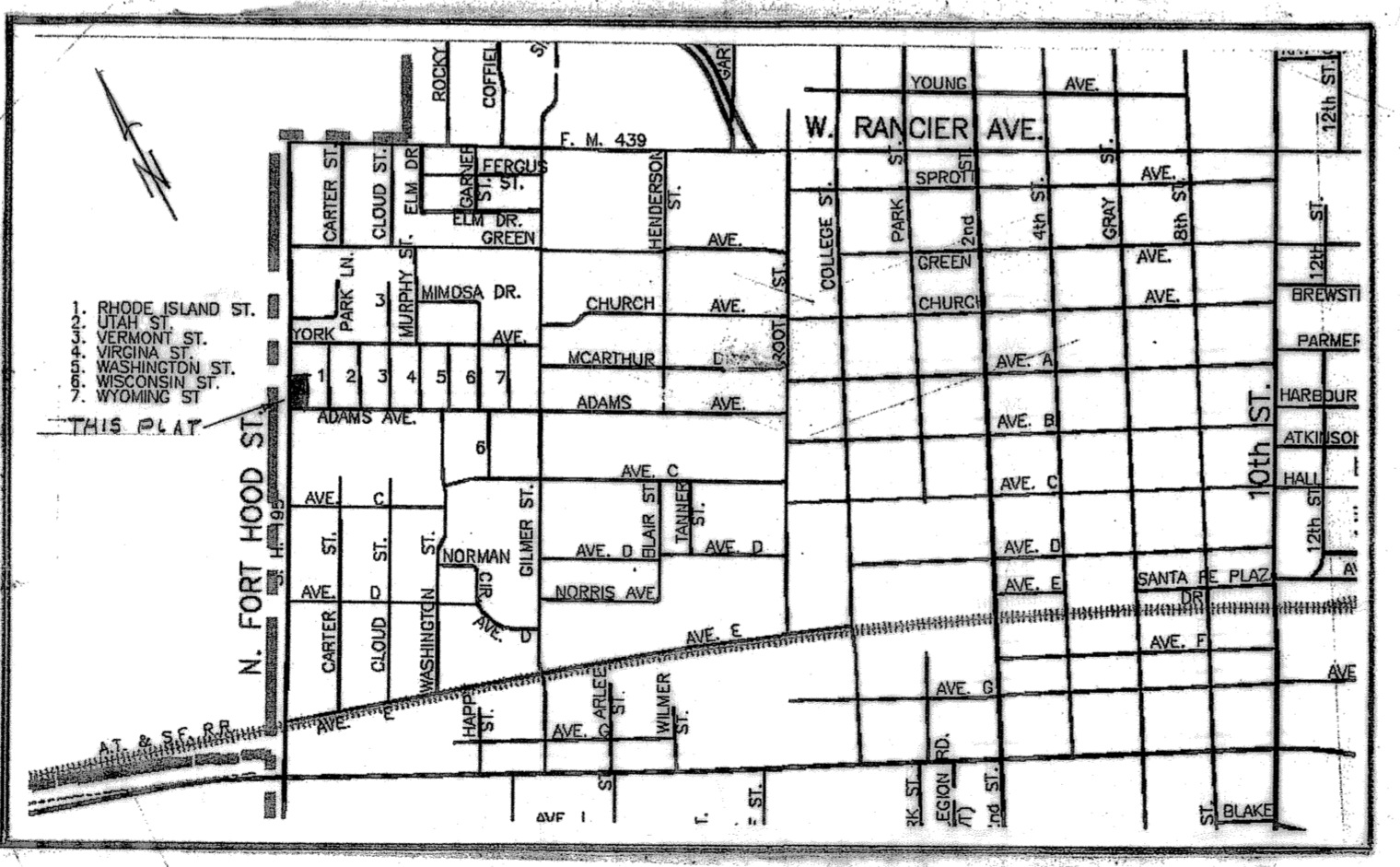

Vicinity Map

Camp Additon Amended
 BEING AN AMENDED PLAT OF LOTS 10, 11, AND 12, BLOCK 8 OF CAMP ADDITION
 Killeen, Bell County, Texas

Maples & Associates, Inc.
 420 S. Liveoak, Ste 200
 P.O. Box 893
 Lampasas, Texas 76550
 Tel (512) 556-2078
 Fax (512) 556-0500

Amended Plat

Drawn By: MM Scale: 1" = 30' 1 Block, 1 Lot 0.268 Acres
 5-14-07