

VICINITY MAP
NTS

KNOW ALL MEN BY THESE PRESENTS, that LELAND EDWARD BUCHANNAN, and wife, AURELIE BUCHANNAN, whose address is 1706 Becker Drive, Killeen, Texas, 76542, being the sole owners of that certain 1.000 acre tract out of the G.W. Farris Survey, Abstract No. 306, Bell County, Texas, which is more fully described in the Dedication of BUCHANNAN ADDITION, as shown by the plat hereof, attached hereto, and made, a part hereon, and approved by the City Council of the City of Killeen, Bell County, Texas, and LELAND EDWARD BUCHANNAN, and wife, AURELIE BUCHANNAN, do hereby adopt said BUCHANNAN ADDITION, as an addition to the City of Killeen, Bell County, Texas, and hereby dedicate to said City all streets, avenues, roads, drives and alleys shown on said plat, the same to be used as public utilities when and as authorized by the City of Killeen. The utility easements shown on said plat are dedicated to said City for the installation and maintenance of any and all public utilities, which the City may install or permit to be installed or maintained.

Leland E. Buchanan
LELAND EDWARD BUCHANNAN

Aurelie Buchanan
AURELIE BUCHANNAN

BEFORE ME, the undersigned, a Notary Public in and for said County and State, on this day personally appeared LELAND EDWARD BUCHANNAN, and wife, AURELIE BUCHANNAN, known to me to be the persons whose names are subscribed to the foregoing instrument and acknowledged to me that the same was the act of said LELAND EDWARD BUCHANNAN, and wife, AURELIE BUCHANNAN, and that they executed the same for the purpose and consideration therein expressed.

GIVEN UNDER MY HAND AND SEAL OF OFFICE, THIS 18th DAY OF October, 1990.

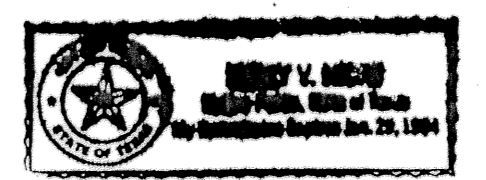

Stacy D. Stimp
NOTARY PUBLIC STATE OF TEXAS

APPROVED this the 4th day of September, 1990, by the Planning Commission of the City of Killeen, Bell County, Texas.

Leonard D. Gulij
CHAIRMAN, PLANNING COMMISSION

Stacy D. Stimp
SECRETARY, PLANNING COMMISSION

FILED for record this 4th day of December, 19 90, in Cabinet B, Slide 200-B
Plat Records of Bell County, Texas.

KNOW ALL MEN BY THESE PRESENTS,
That I, Charles C. Lucko, Registered Professional Land Surveyor, do hereby certify that I did prepare this plat from an actual and accurate survey of the land, the corner monuments shown thereon were properly placed under my personal supervision in accordance with the subdivision regulations of the City of Killeen, Texas, and this subdivision is within the City Limits of Killeen, Texas.

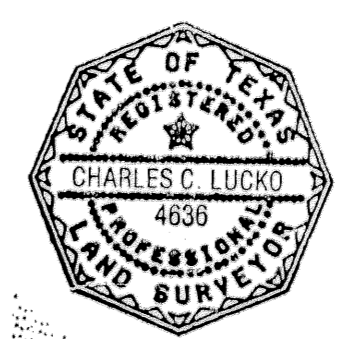

Charles C. Lucko
Charles C. Lucko
Registered Professional Land Surveyor
No. 4636

2 LOTS
1.00 ACRES

| REVISIONS: |
|----------------------|
| 8-16-90 10' DE added |
| 10-2-90 Text Removed |
| |
| |

FINAL PLAT
BUCHANNAN ADDITION
KILLEEN, BELL COUNTY, TEXAS

ALL COUNTY SURVEYING
PO BOX 10092 KILLEEN, TEXAS 76547
(817) 634-4636

Project No. 900704-197
Date: 7-17-90
Drawn By: DC ORDNER
Checked By: C. LUCKO
Drawing No.